

ONBETAALBAAR

SCHETSONTWERP

23.03.2022

FINAAL ONTWERP TIMELAB - GELIJKVLOERS

ALGEMENE MATERIALISATIE



OKOUME MULTIPLEX
TOEPASSING:
FRONTEN, LEGPLANKEN
HERKOMST :
WEST-AFRIKA
SAMENSTELLING:
FSC HOUT

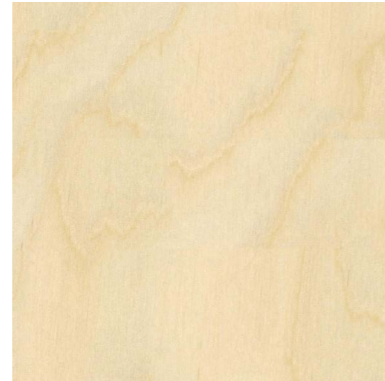

BERK MULTIPLEX
TOEPASSING:
FRONTEN, LEGPLANKEN, ZITVLAK
BANKEN, LATJES LAMBRISERING
HERKOMST:
RUSLAND
SAMENSTELLING:
FSC HOUT



POOLSE GRELEN MULTIPLEX
TOEPASSING:
FRONTEN, LEGPLANKEN,
VESTIARE
HERKOMST:
POLEN
SAMENSTELLING:
FSC HOUT



ECOBOARD
TOEPASSING:
CORPUSSEN, OPSTAANDE ZIJDEN
BANKEN, BASIS LAMBRISERING
HERKOMST:
CHINA
SAMENSTELLING:
LANDBOUWRESTEN UIT RIJSTTEELT



CIRCULAIR MATTERS
TOEPASSING:
CORPUSSEN, OPSTAANDE ZIJDEN
BANKEN, BASIS LAMBRISERING
HERKOMST:
BRUSSEL
SAMENSTELLING:
BIERBOSTEL EN RIET



PLEXWOOD MERANTI
TOEPASSING:
WERKBLAD, TAFELS
HERKOMST :
NEDERLAND
SAMENSTELLING:
FSC HOUT



ORGANOID
TOEPASSING:
LAMBRISERING
HERKOMST :
ZWITSERLAND
SAMENSTELLING:
ROZENBLADEN EN ALPENGRAS

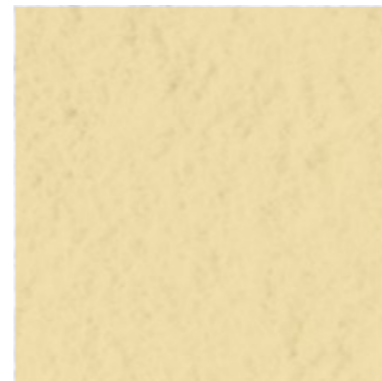

BEVLOKKING / FLOCAGE
TOEPASSING:
PLAFOND
HERKOMST :
ONBEKEND
SAMENSTELLING:
HOOFDZAKELIJK MINERALE WOL



ROTOR DC
TOEPASSING:
ACCENTLAMPEN BAR
(GELIJKAARDIG)
HERKOMST :
TWEEDEHANDS

ALGEMENE MATERIALISATIE

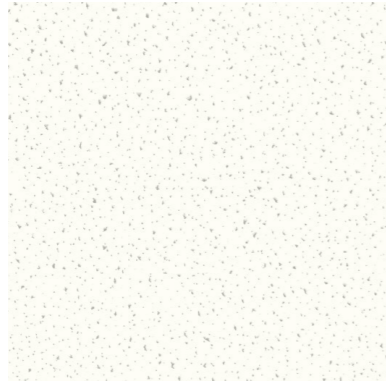

GIETVLOER
TOEPASSING:
VLOER
HERKOMST :
DUITSLND
SAMENSTELLING:
KROK EN LIJNZAADOLIE



MESSING
TOEPASSING:
TOOG, SPATWAND EN VINNEN
HERKOMST:
ONBEKEND
SAMENSTELLING:
KOPER EN ZINK



SPIEGELLAMINATI
TOEPASSING:
ONDER MEUBILAIR EN LAMBRIS-
ERING
HERKOMST:
ONBEKEND
SAMENSTELLING:
ALUMINIUM



SKAI STOFFERING
TOEPASSING:
STOFFERING STOELN
HERKOMST:
ONBEKEND
SAMENSTELLING:
VINYL EN POLYESTER

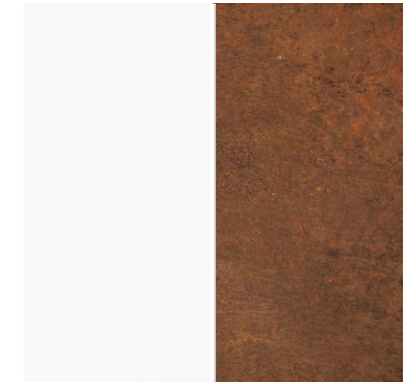

VERROEST EN GELAKT STAAL
TOEPASSING:
POTEN TAFELS EN STOELN
HERKOMST :
TWEDEHANDS ONDERSTELLEN
SAMENSTELLING:
STAAL

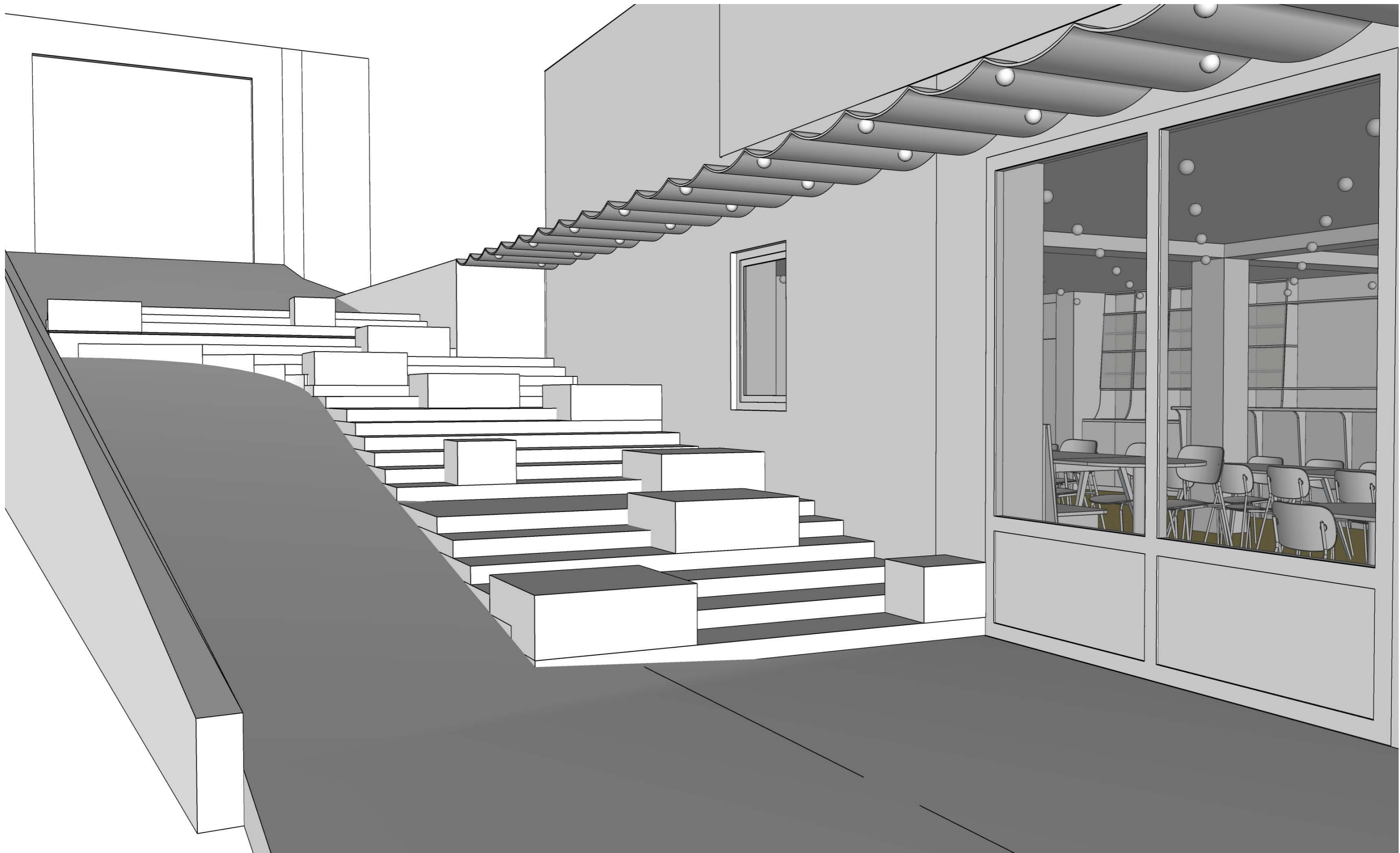

overzicht- terras en luifel

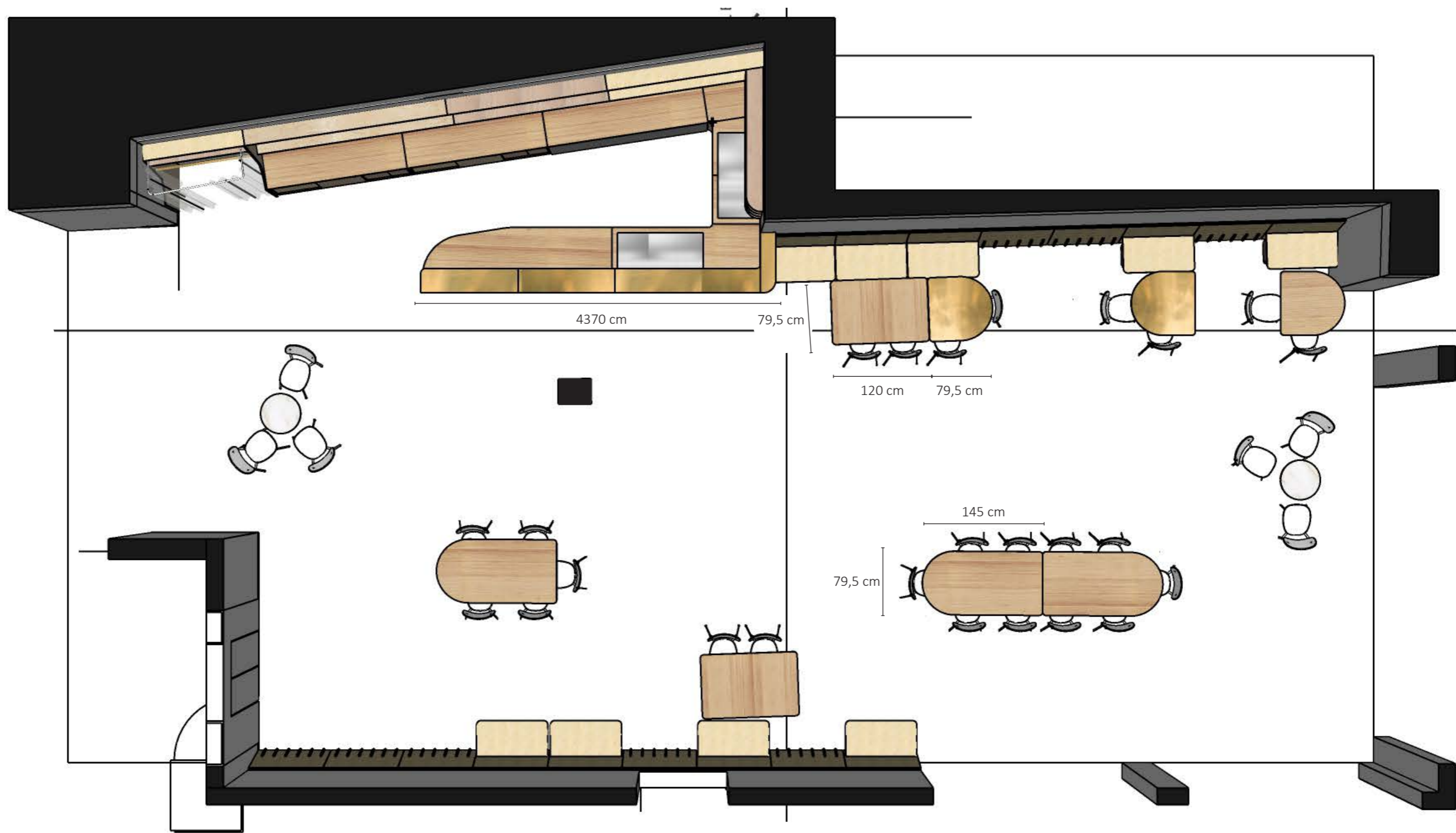

plan - overzicht

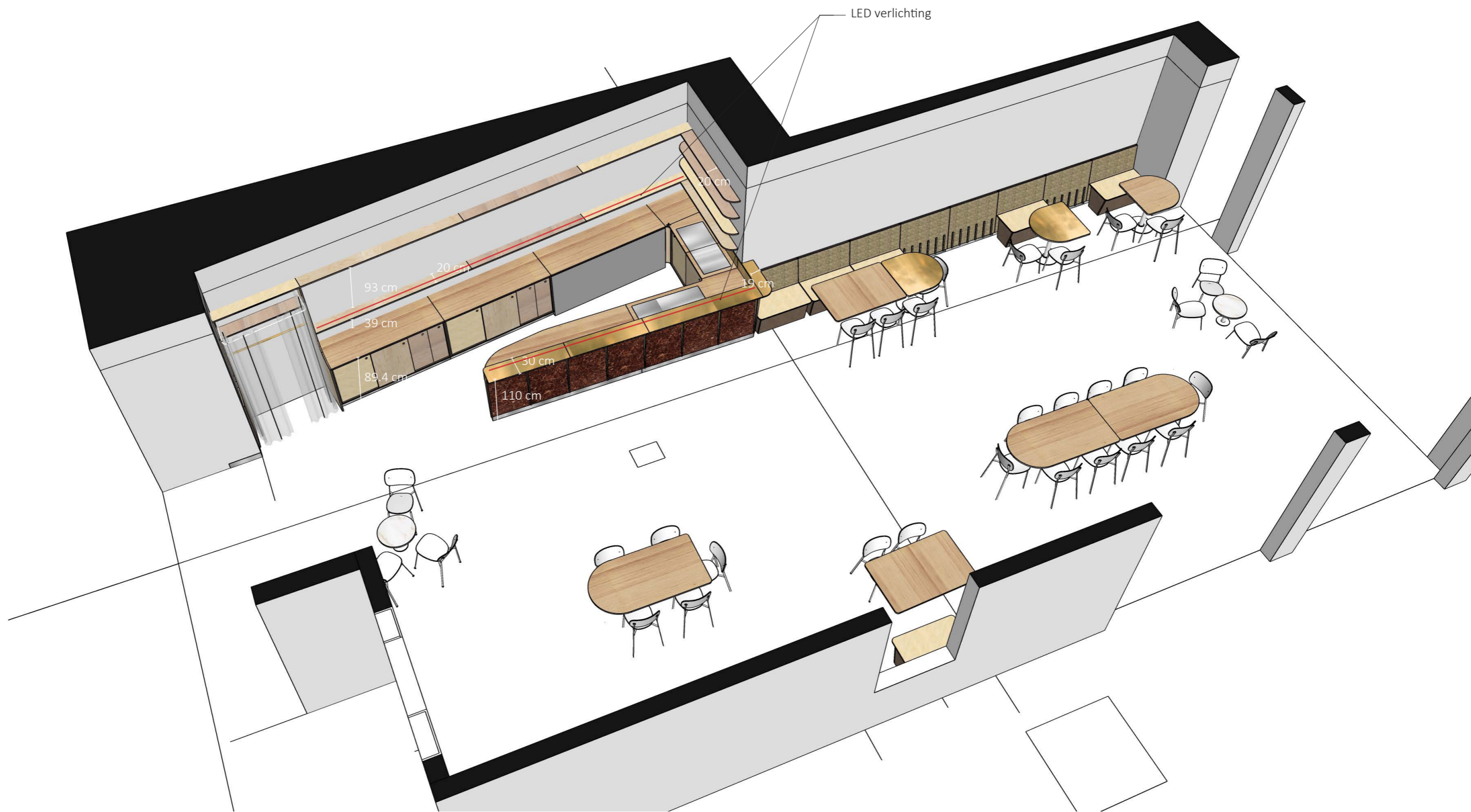

overzicht

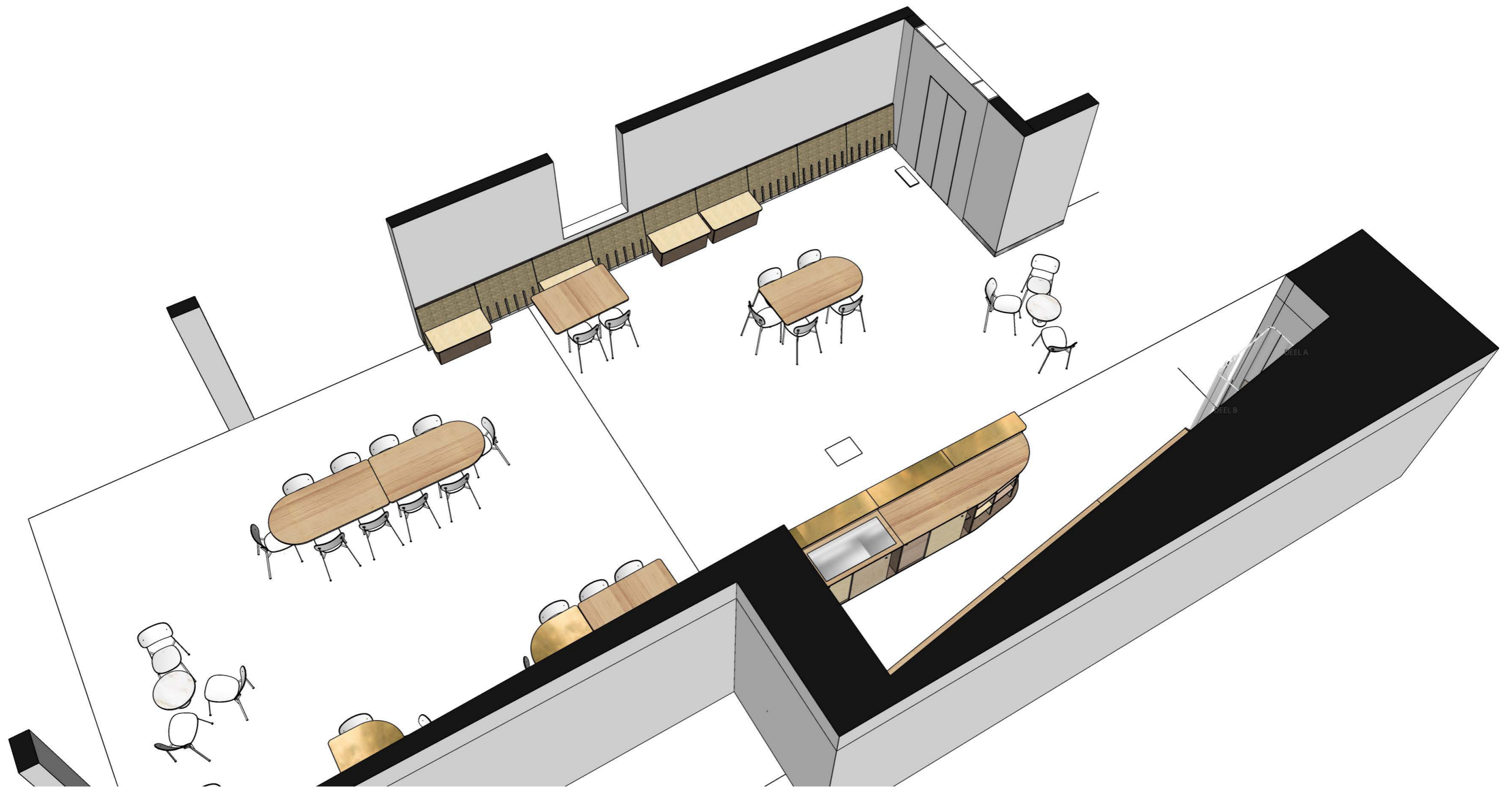

overzicht

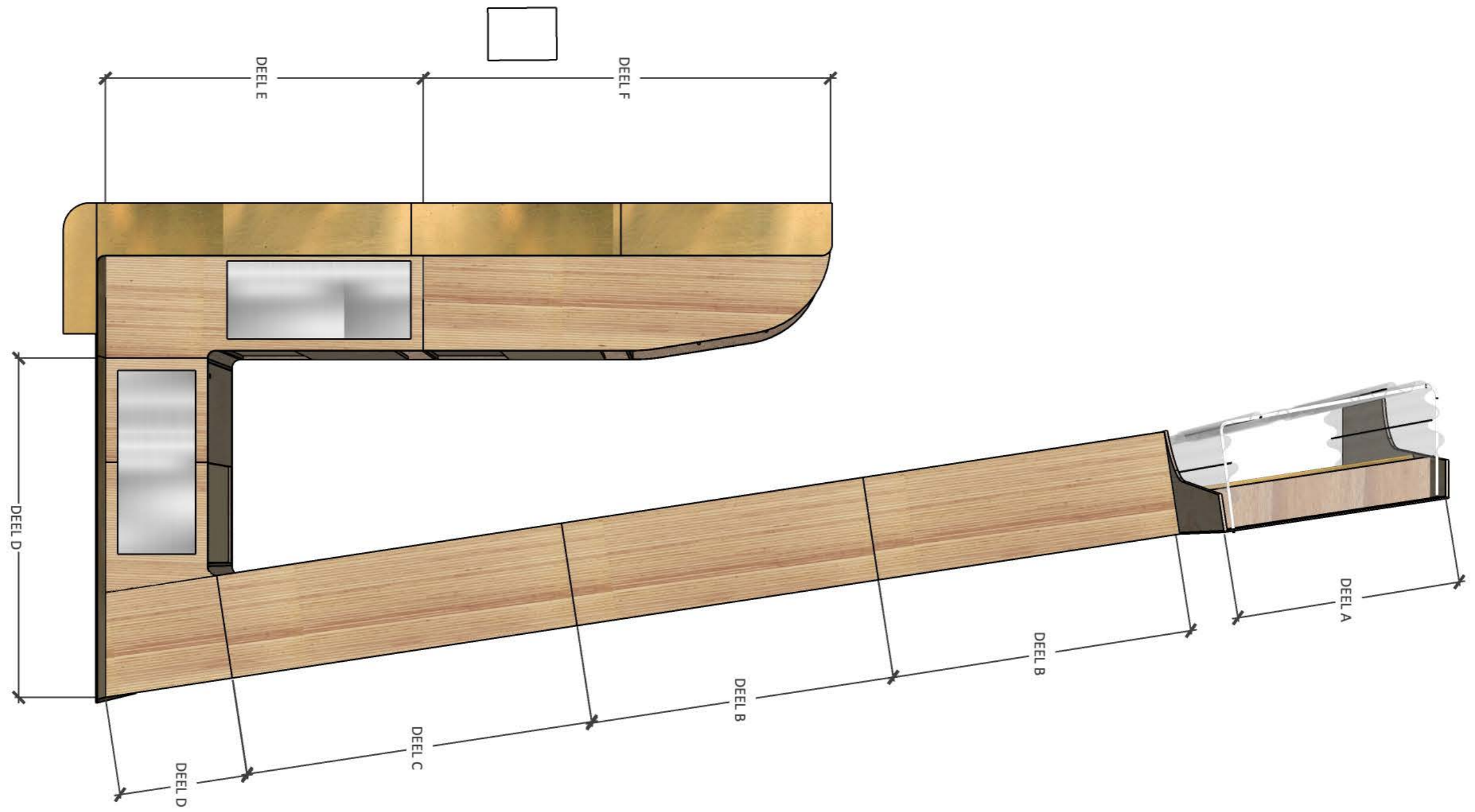

overzicht bar gedeelte

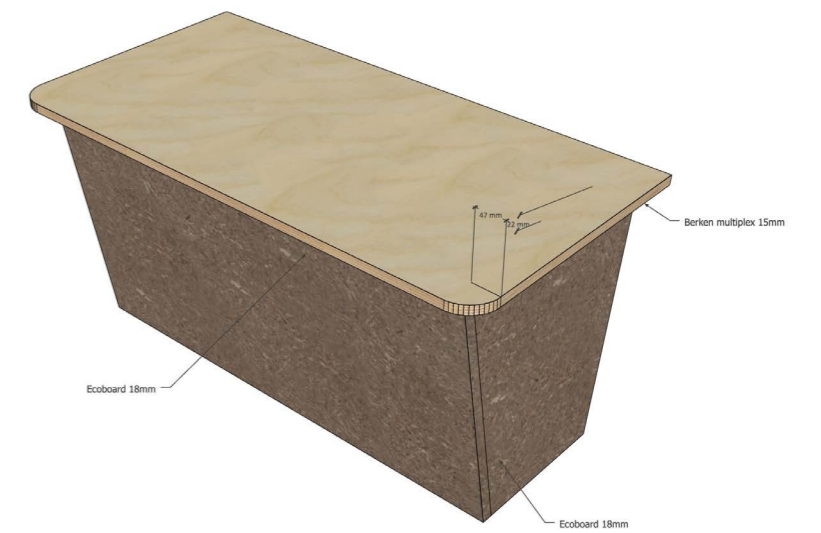
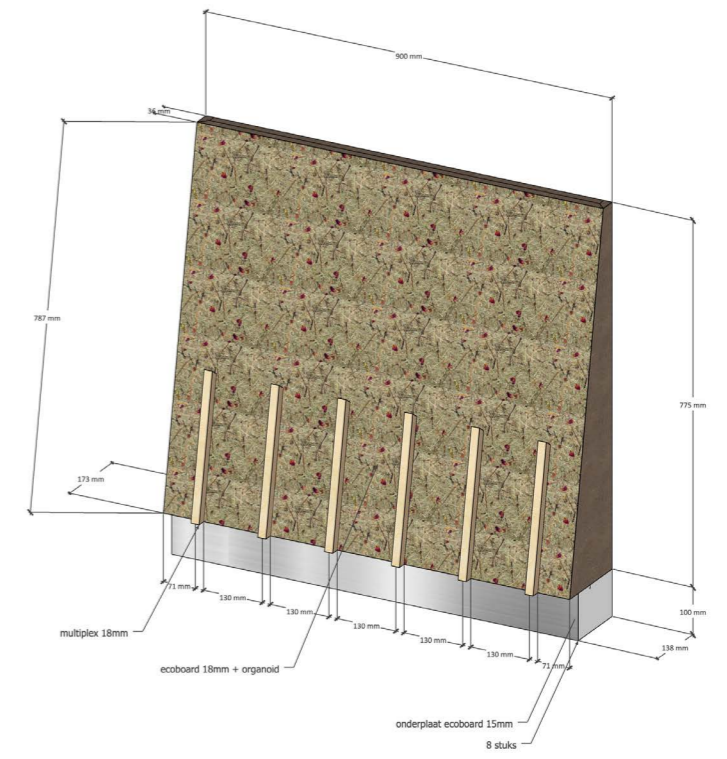
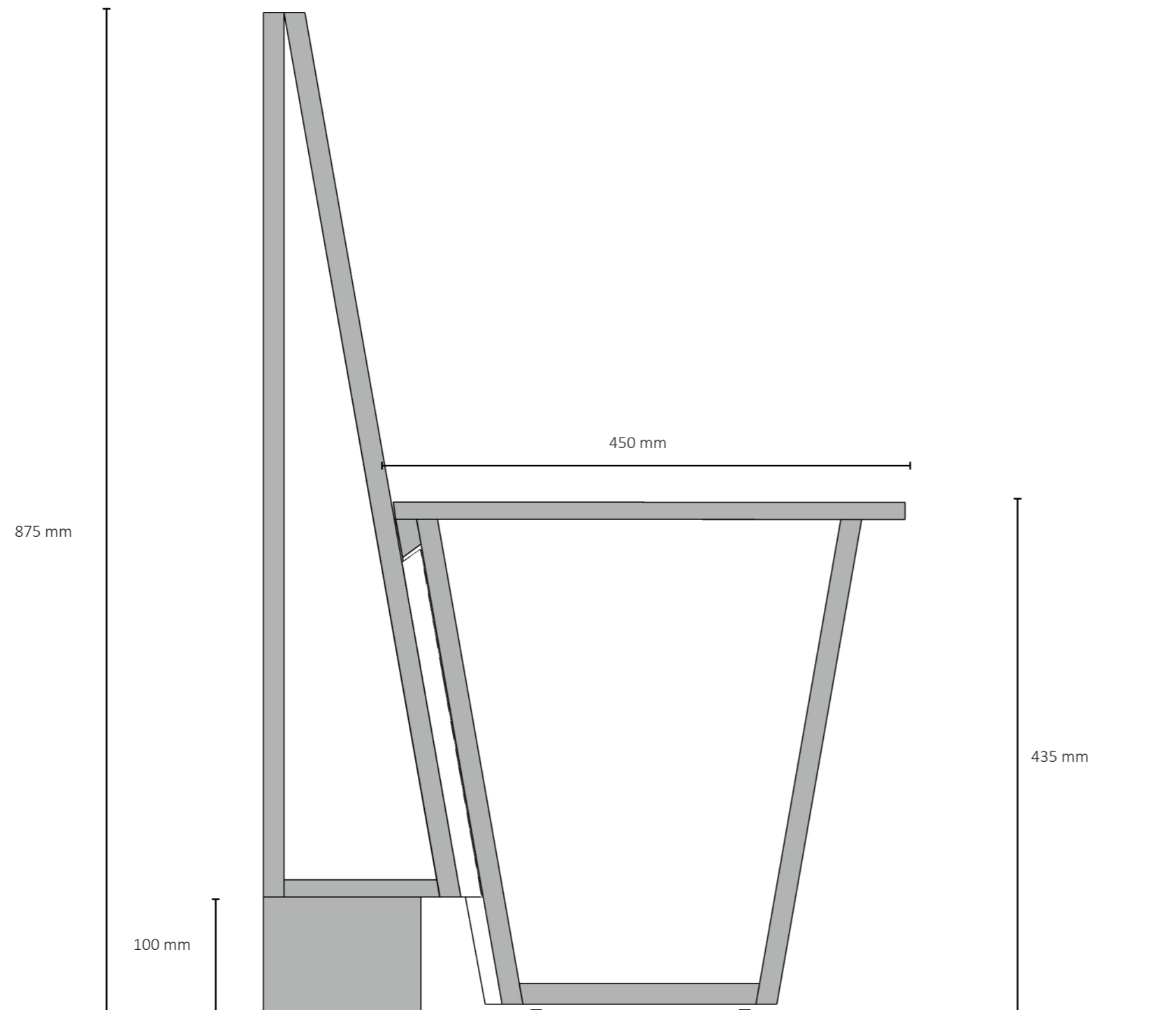

overzicht lambrisering en bankjes

hoek ifv aansluiting kast en muur
ter plaatse aan te zagen

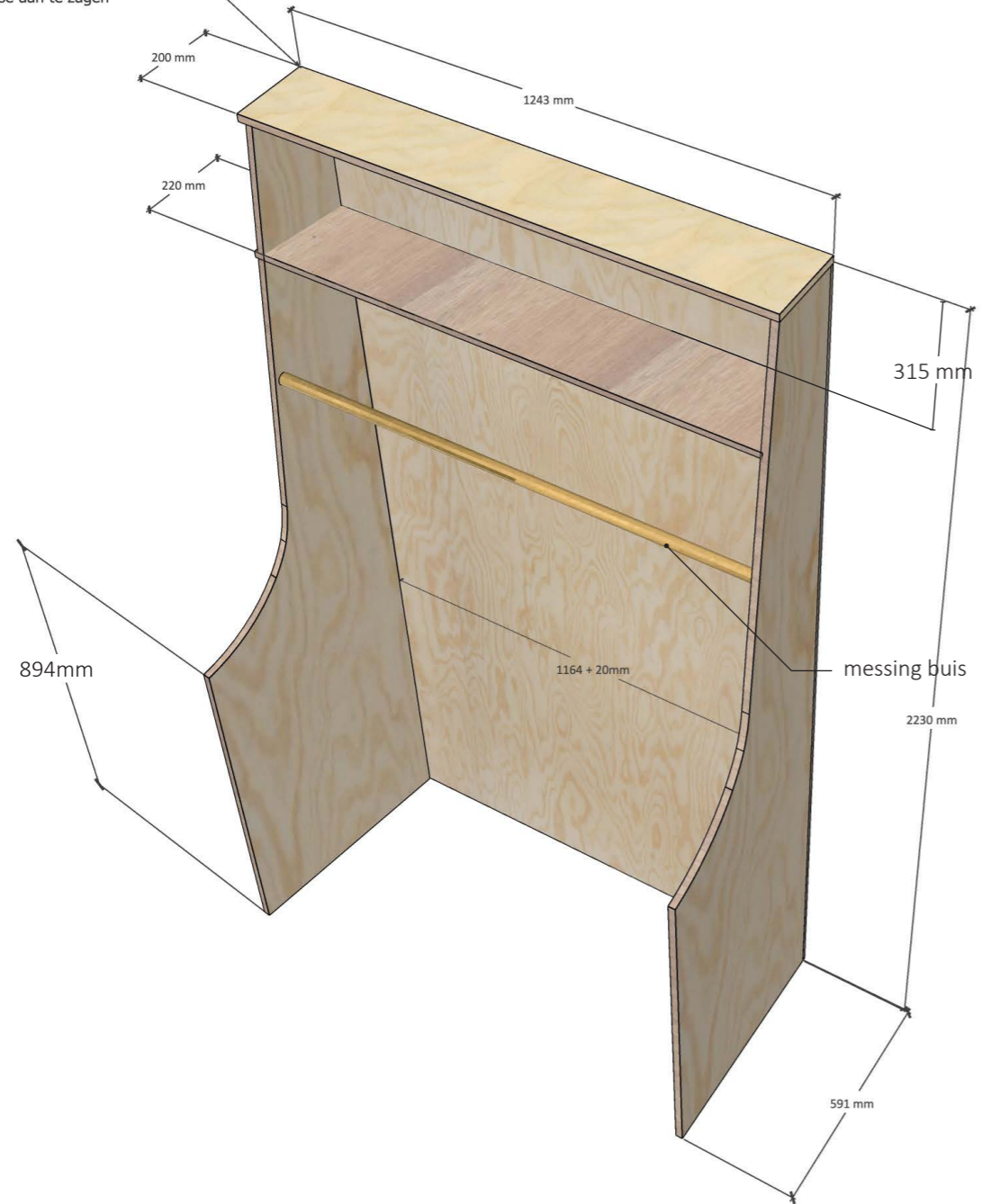

DA_overzicht

DEEL A

rug - poolse grenen mpx 9mm



DA_achteraanzicht

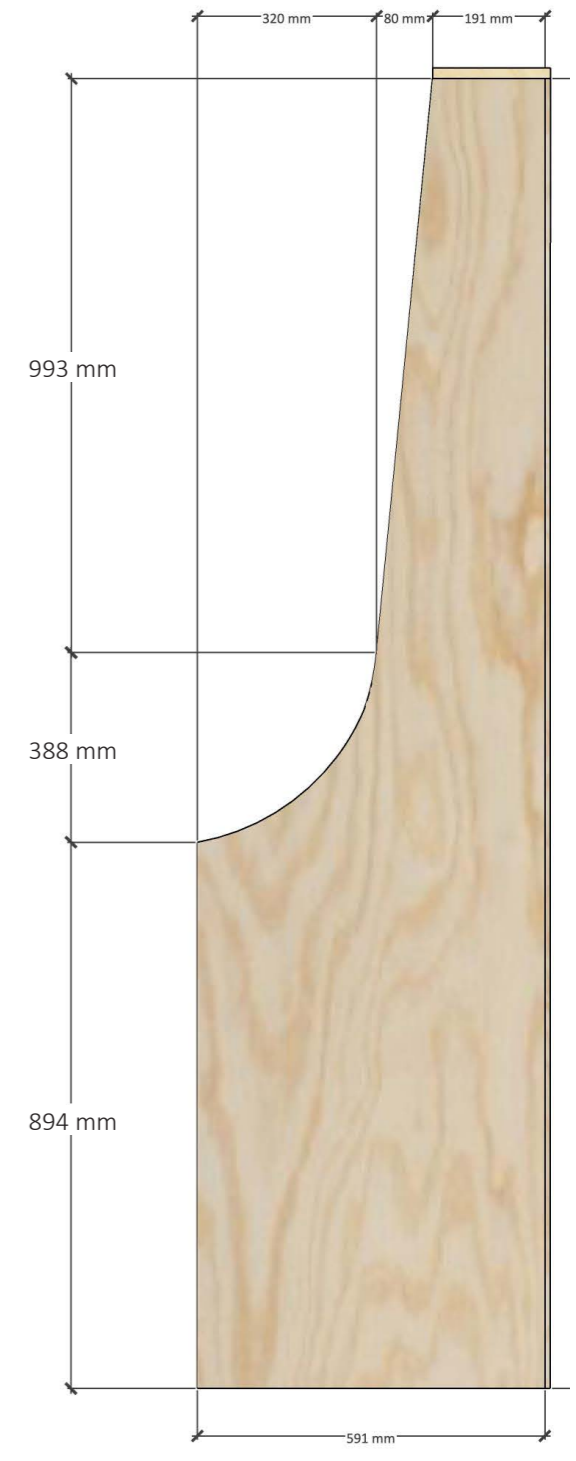

DA_zijaanzicht

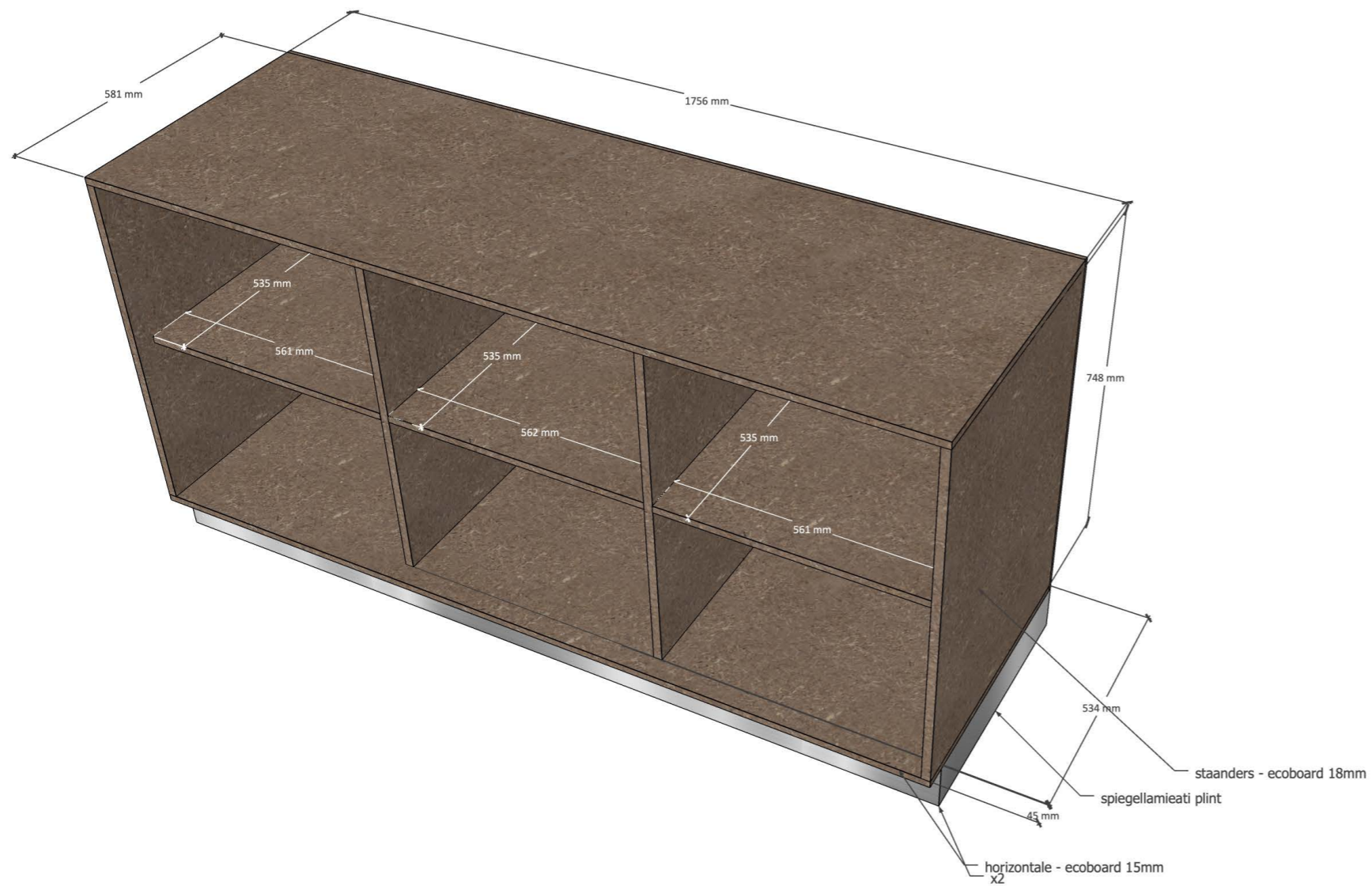

DB_zonder fronten

DEEL B - dit deel moet x2 gemaakt worden!!!

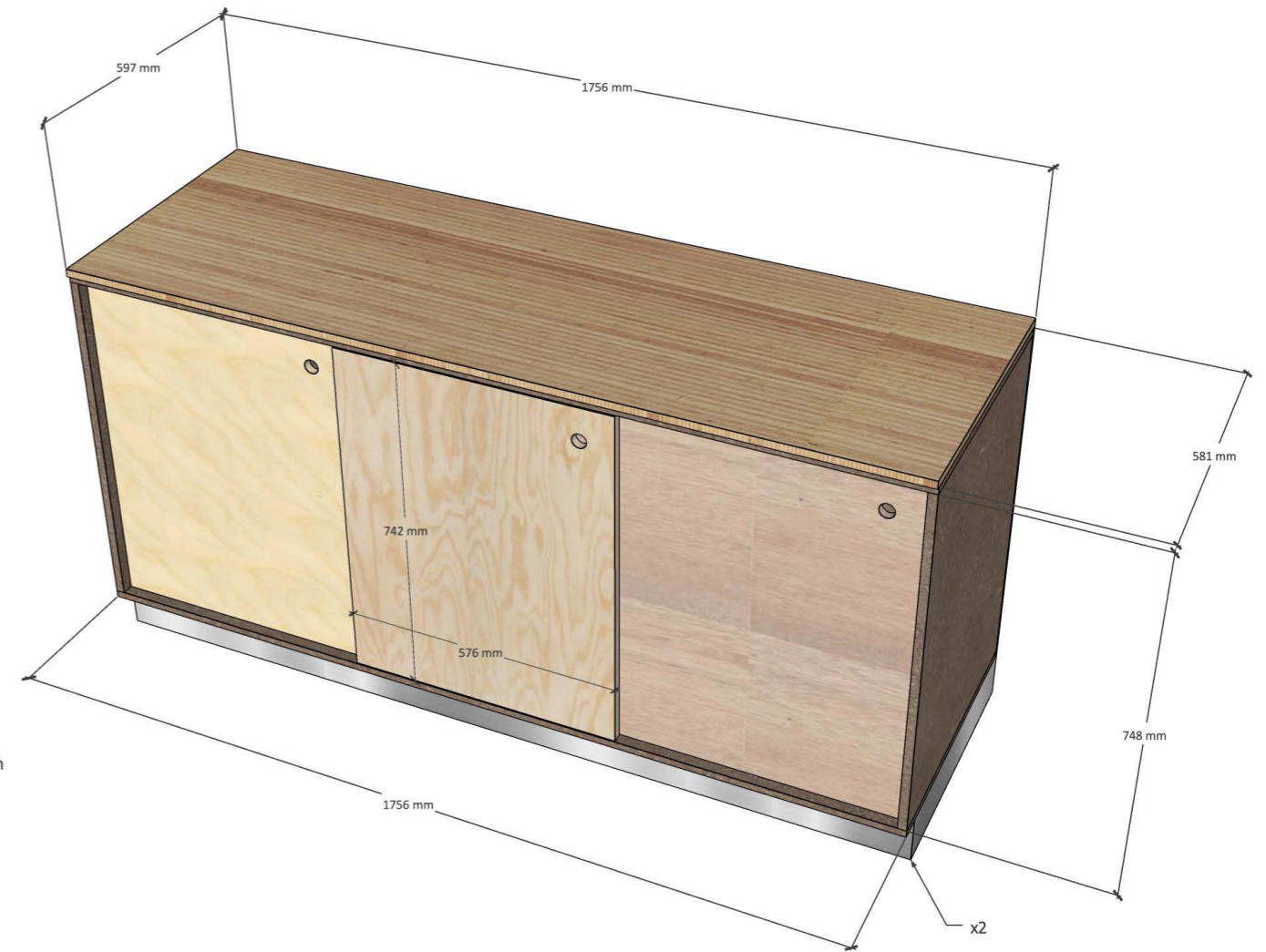

DB_met fronten

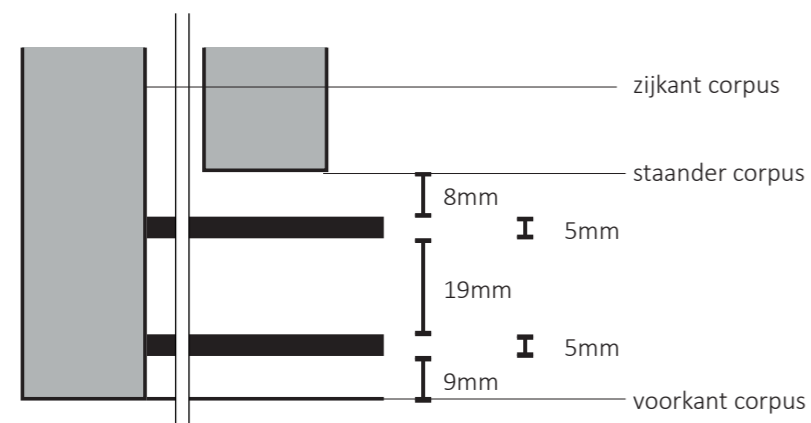

Details infrezing voor schuifdeuren

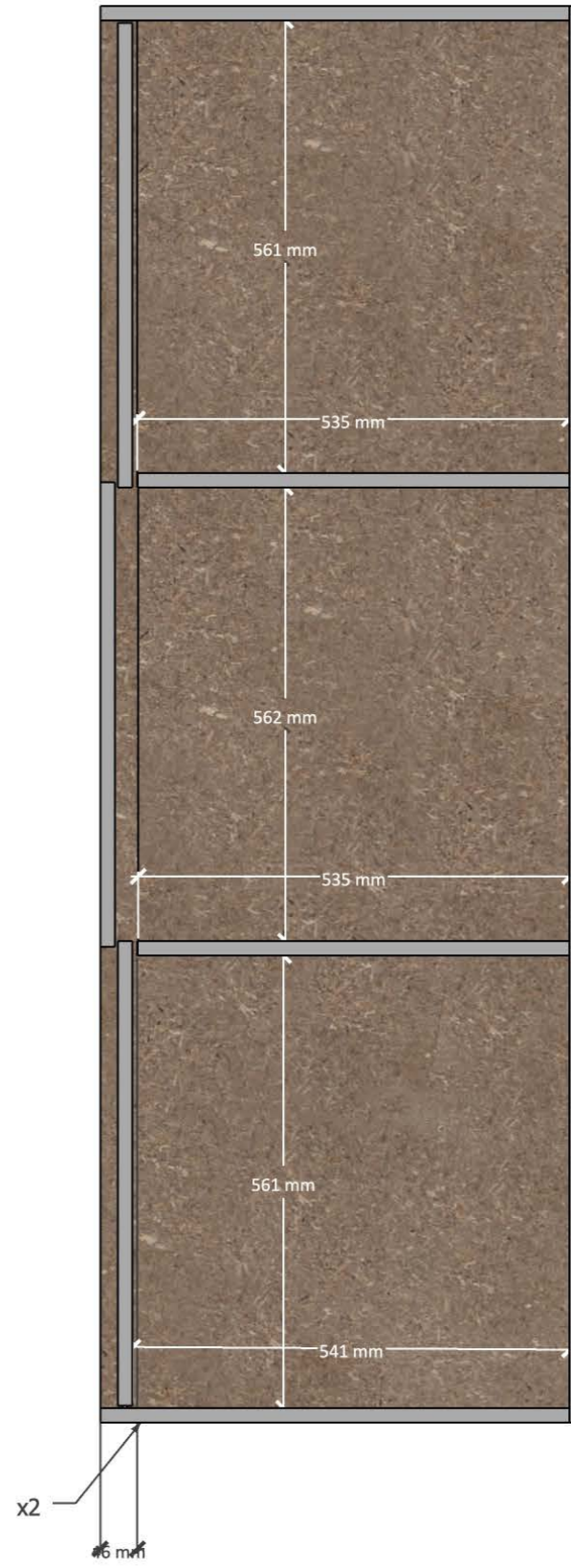

DB_sneede door corpus

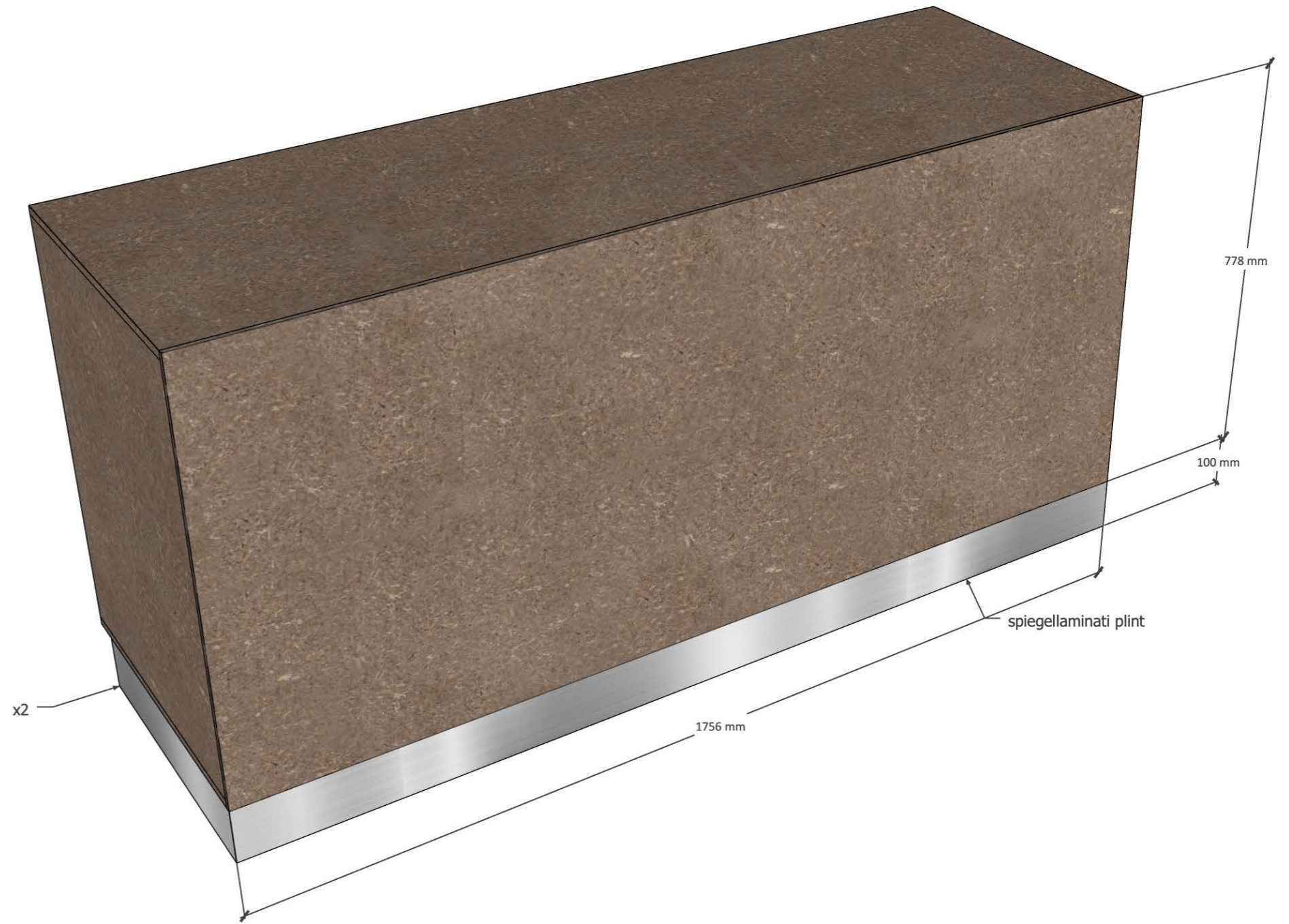

DB_rug

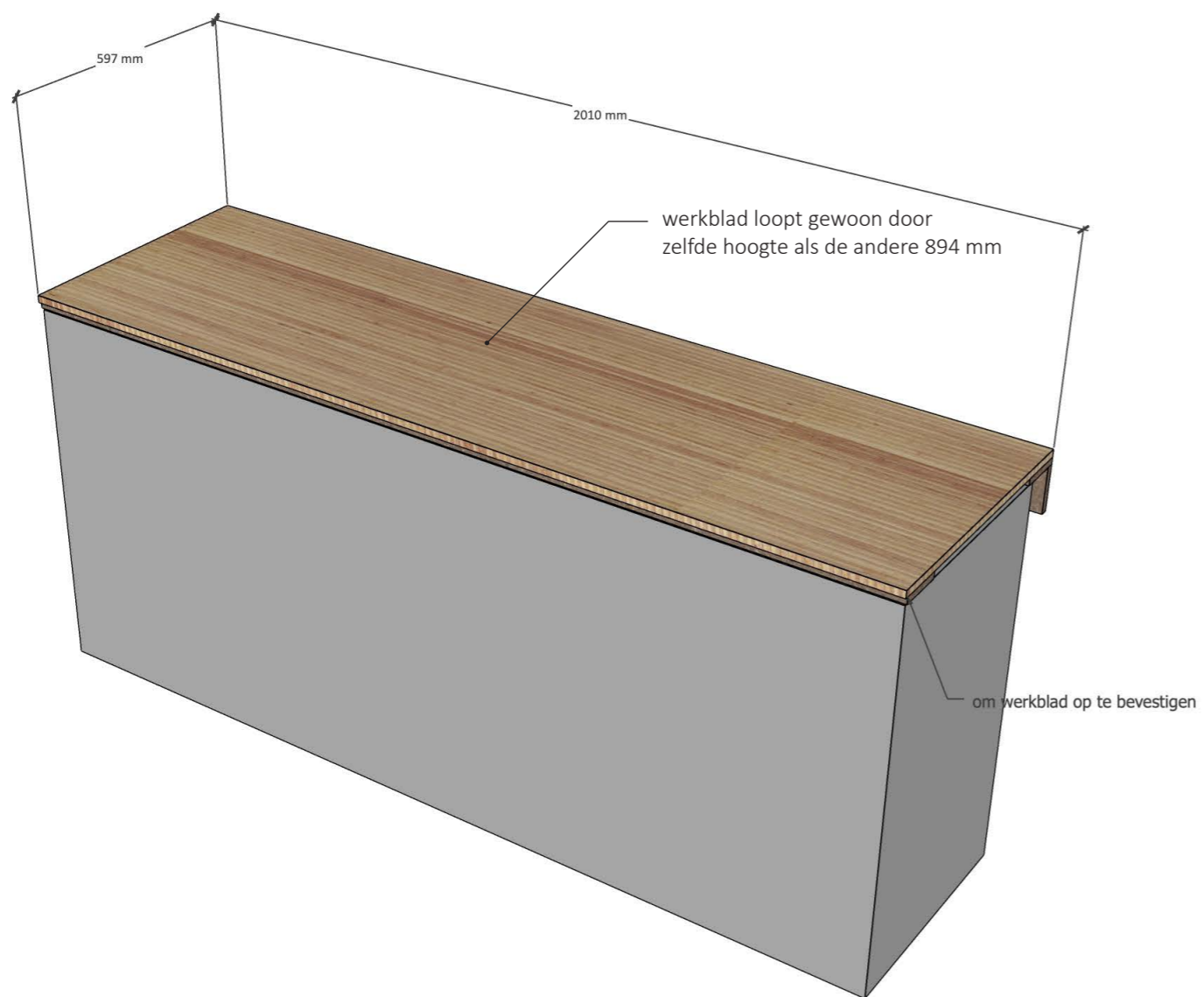

DC_overzicht werkblad boven koelkasten

DEEL C

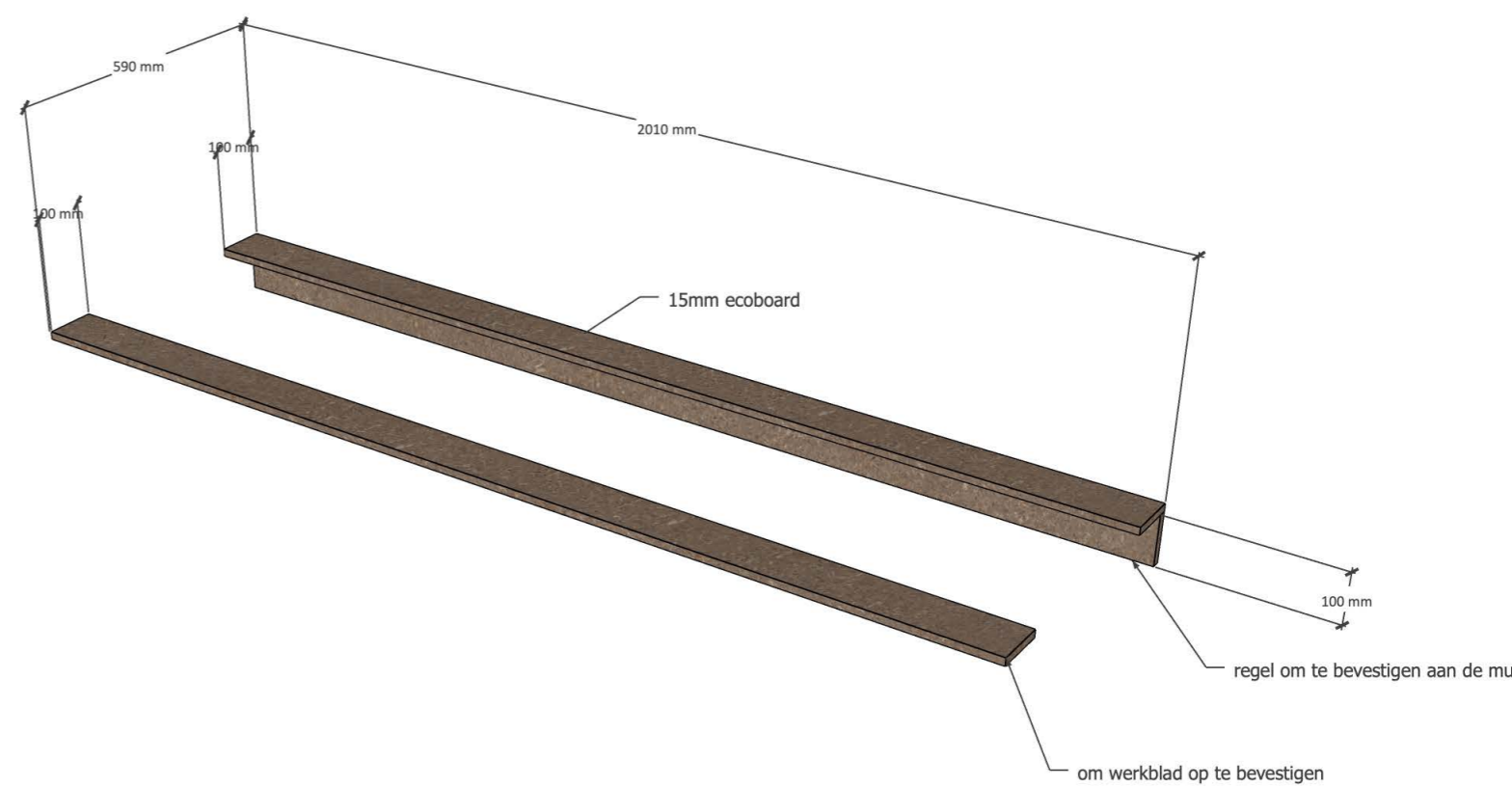

DC_overzicht zonder werkblad

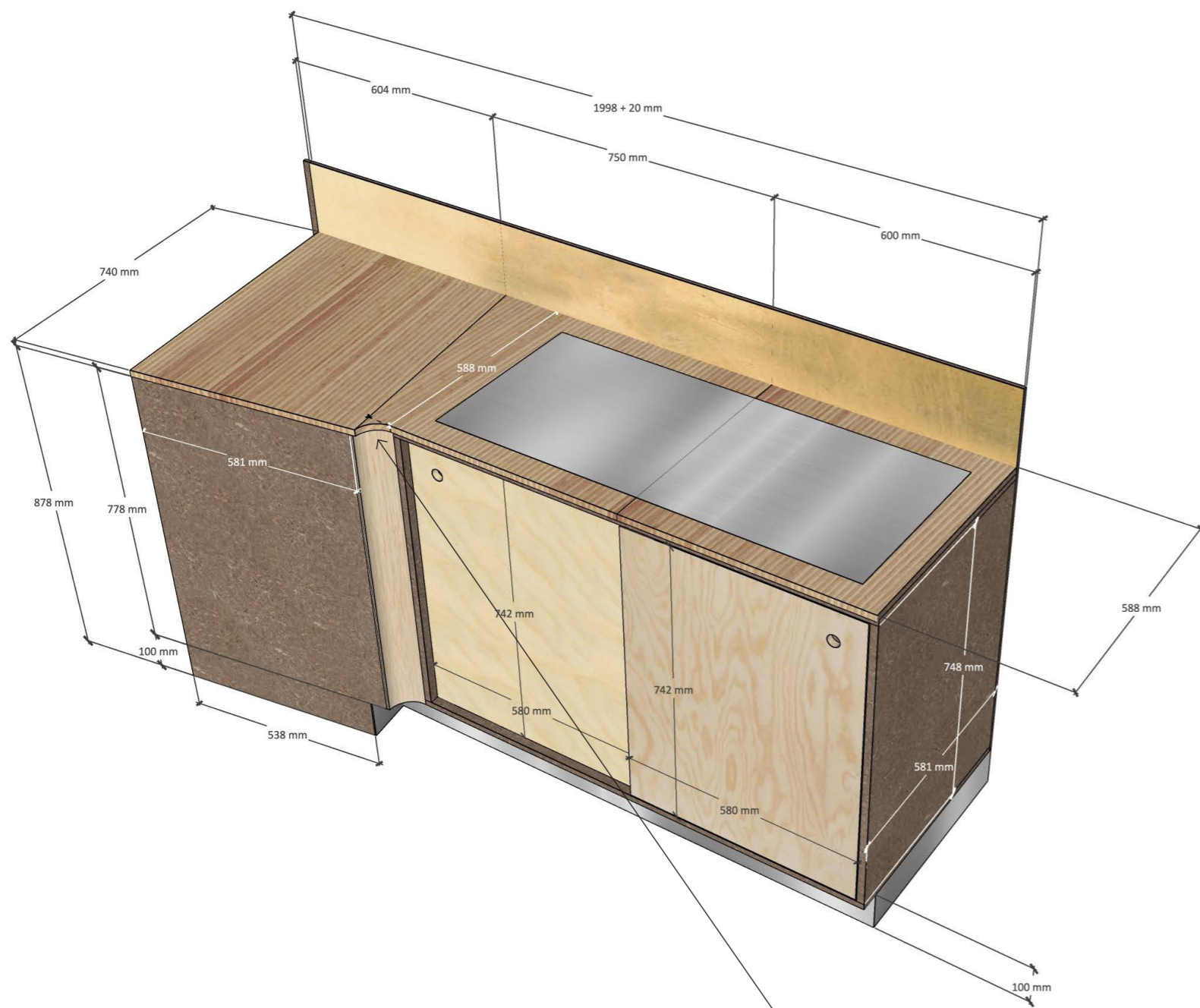

DD_overzicht met fronten

DEEL D

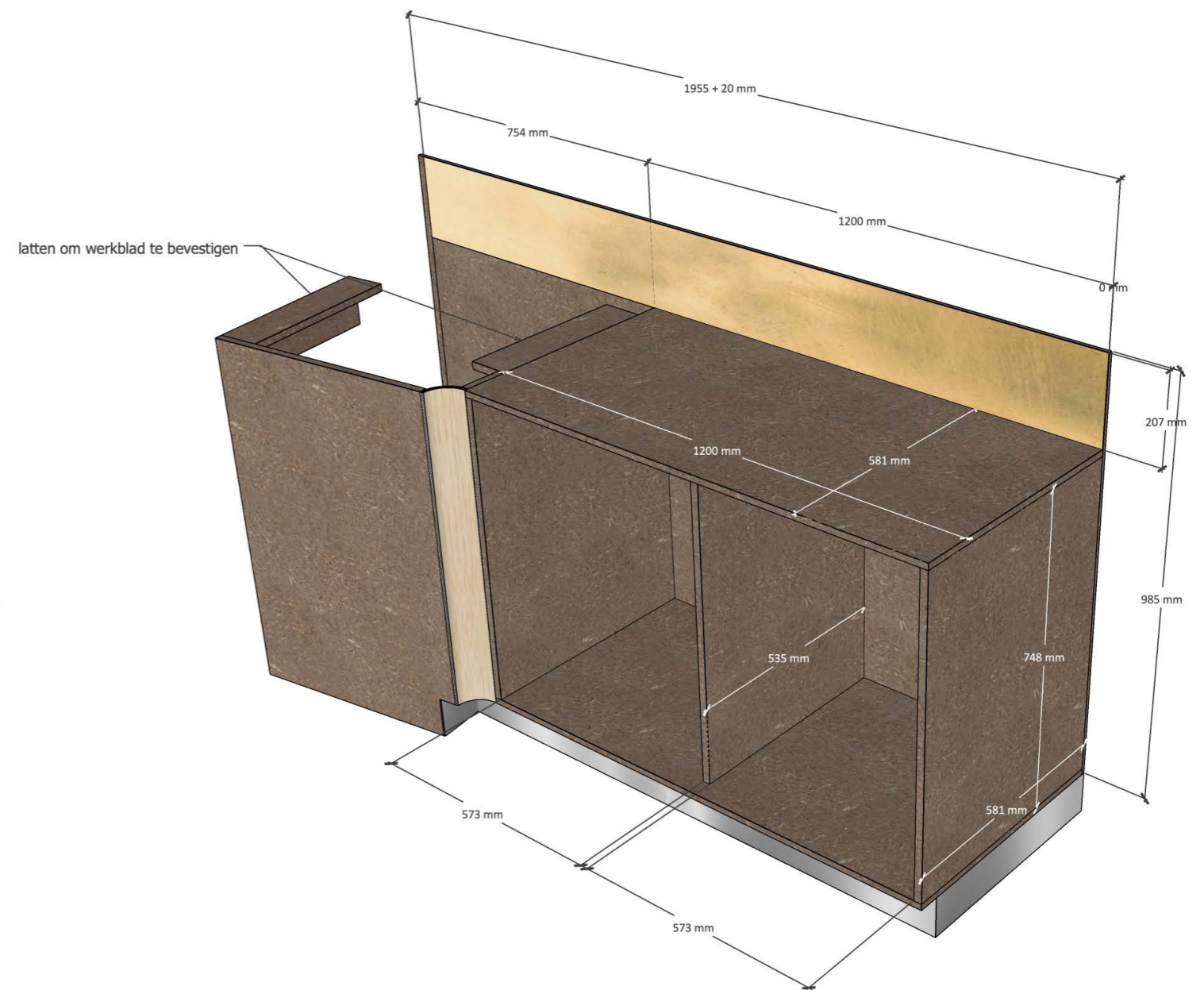

DD_overzicht zonder fronten

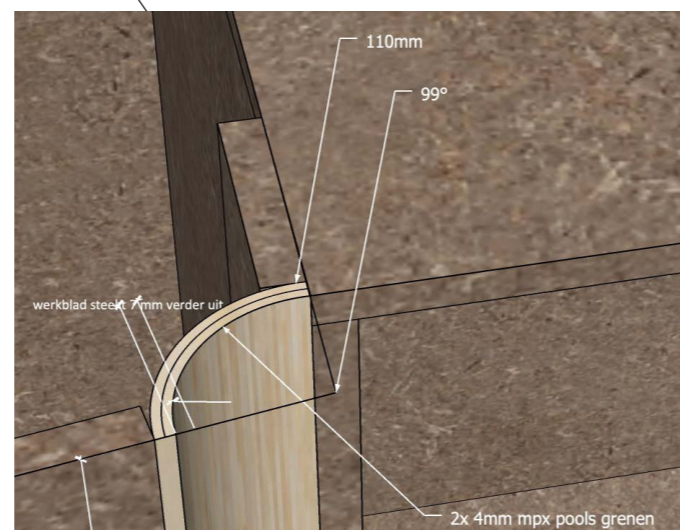

DD_detail rond gedeelte

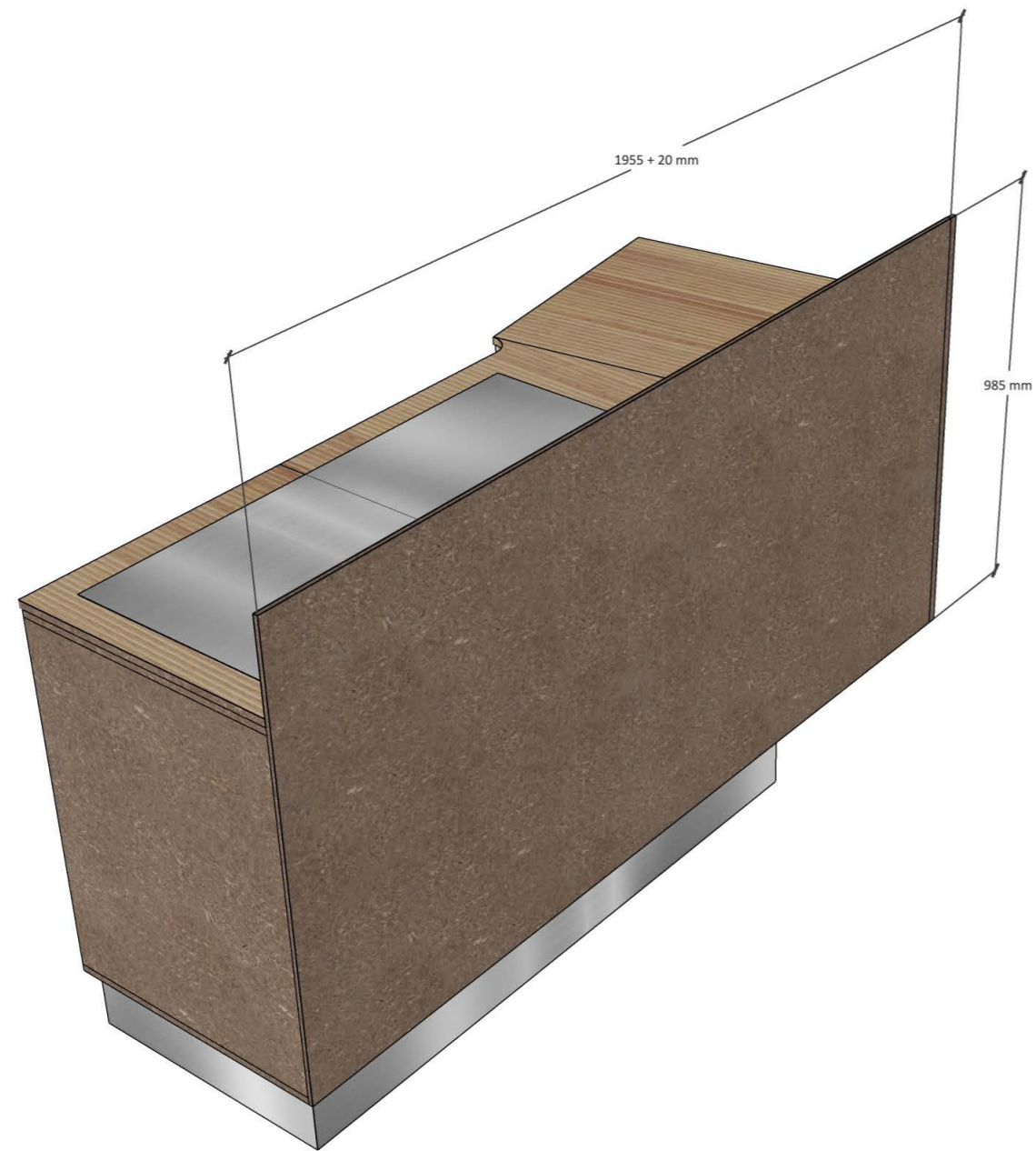

DD_rug

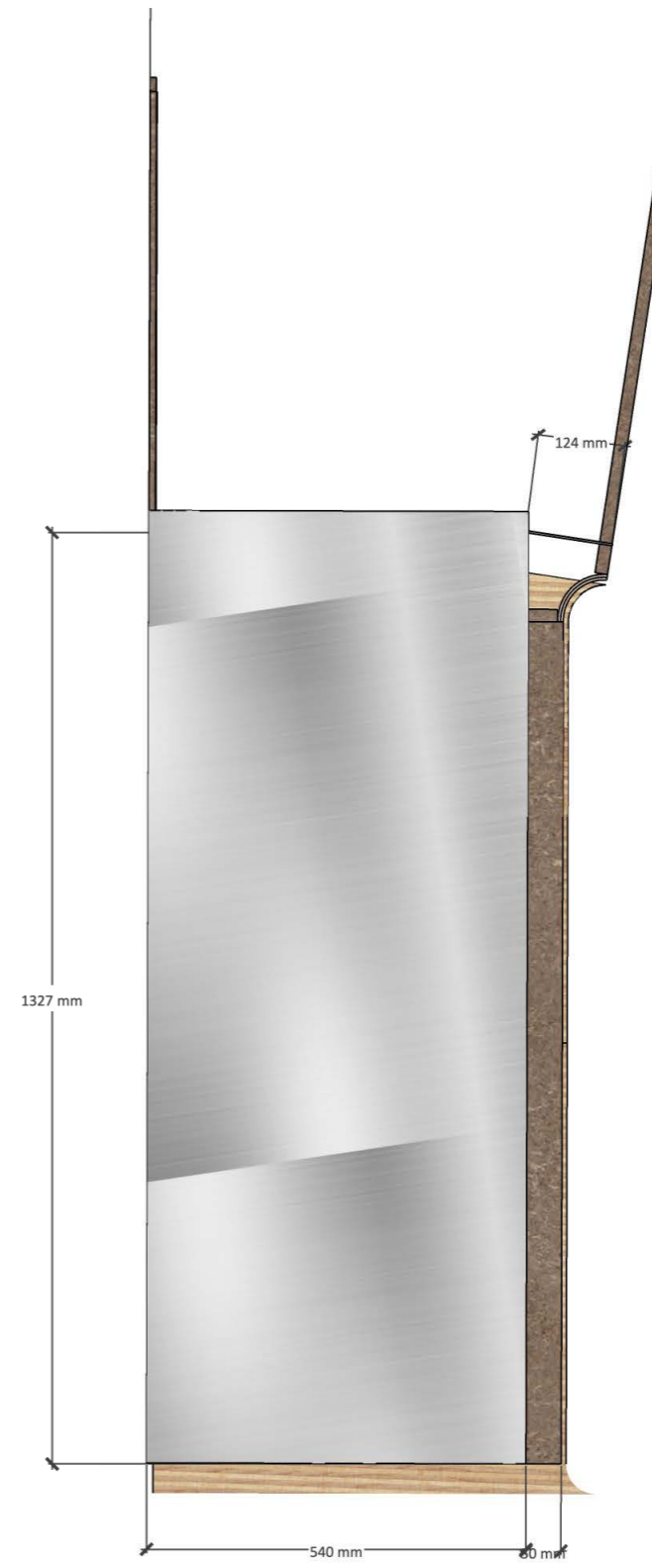

DD_sokkel

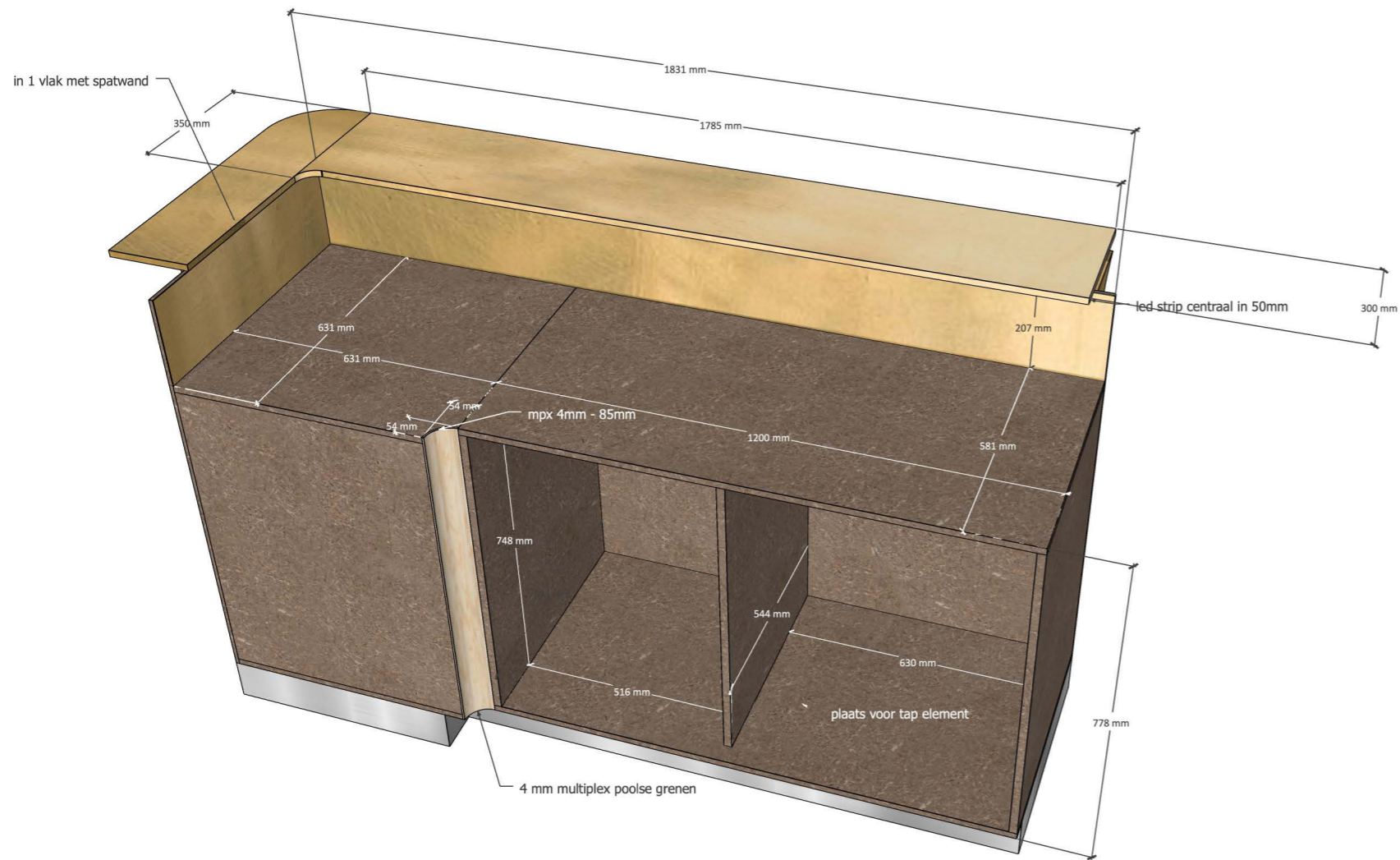

DE_overzicht zonder fronten

DEEL E

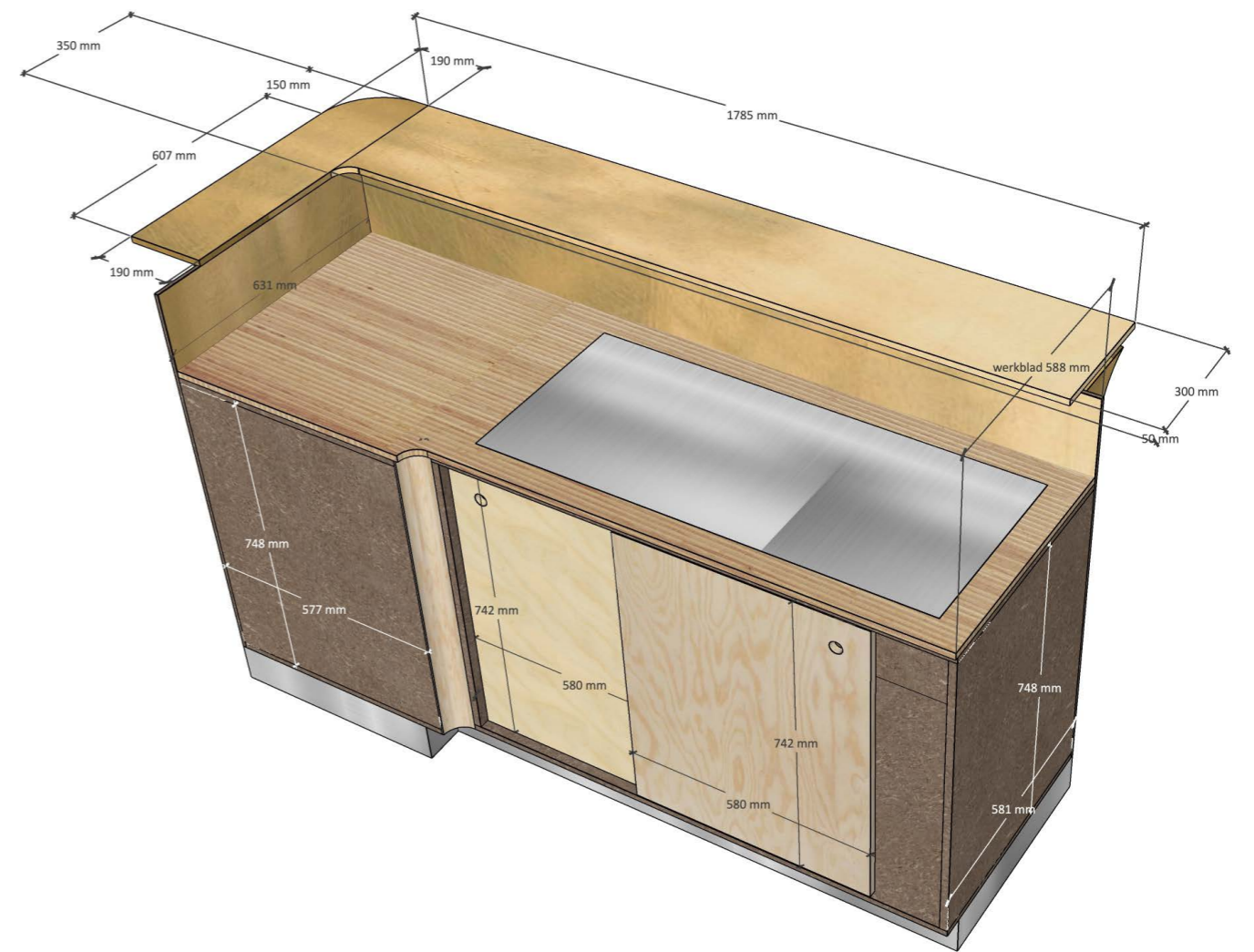

DE_overzicht met fronten

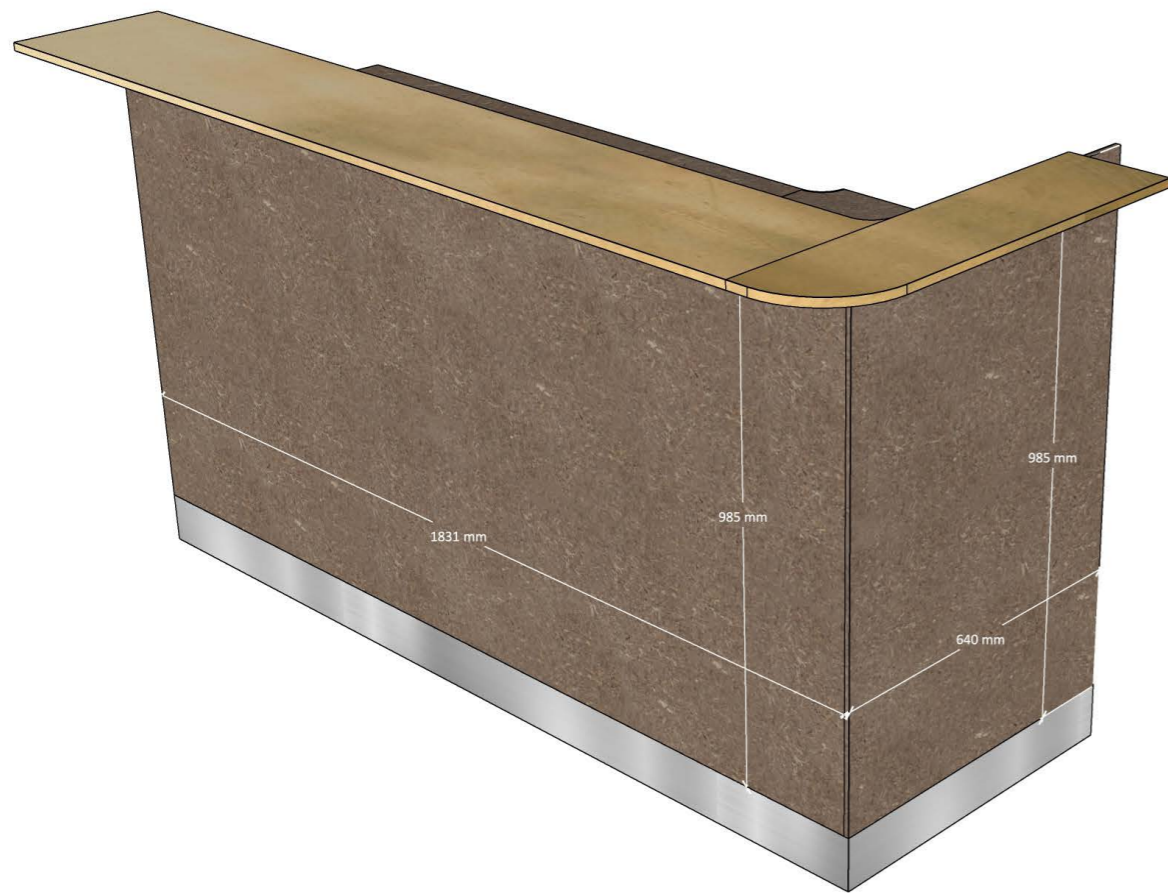

DE_kijkend op de bar vanuit de zaal, rug
zonder CM platen en vinnen

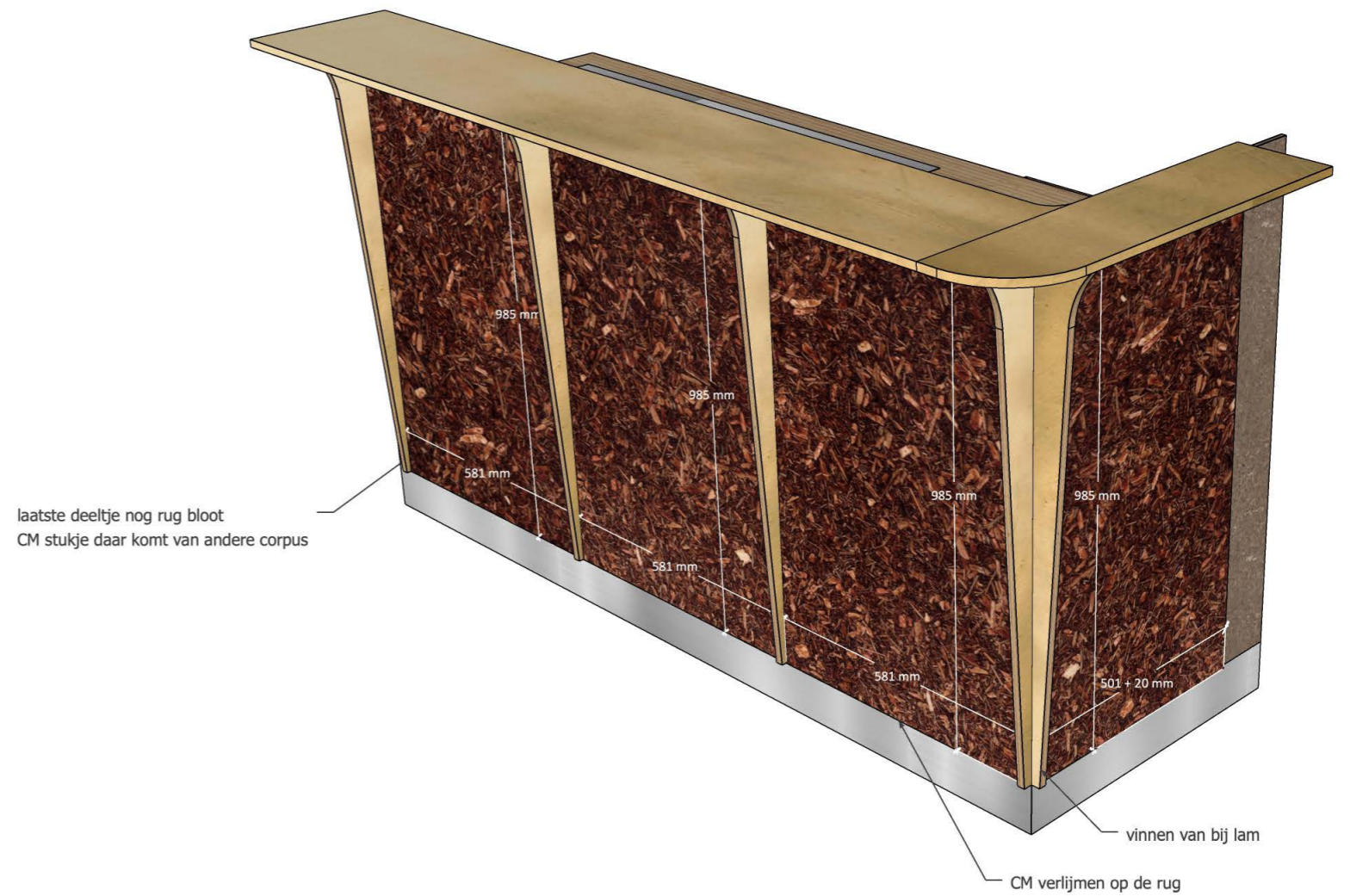

DE_kijkend op de bar vanuit de zaal, afgewerkt met
vinne en CM platen

vinnen te bevestigen op rug

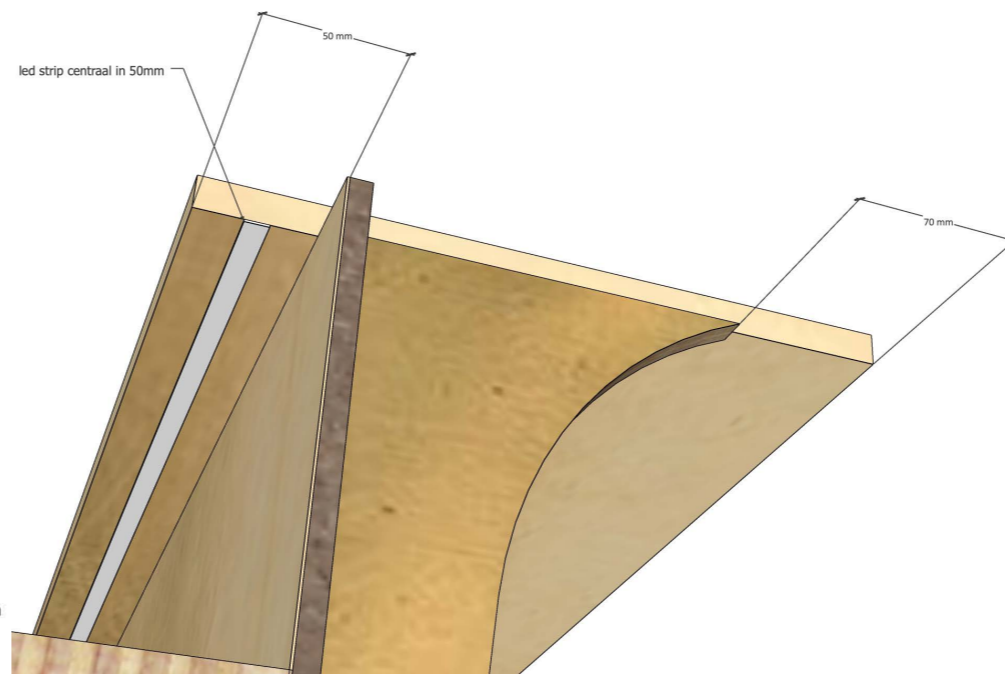
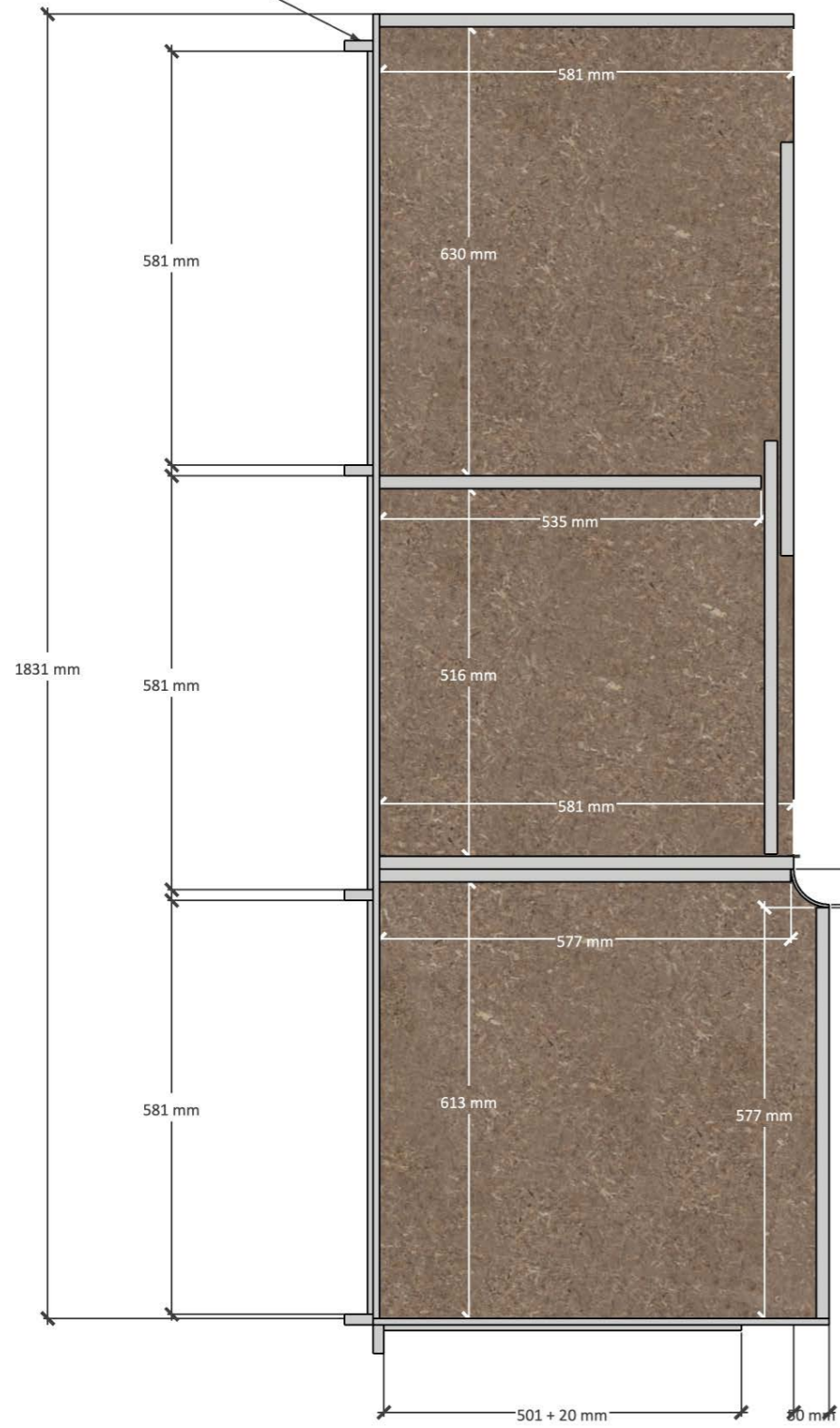

DE_detail hoe toog aansluit op rug en tevens spatwand (CM platen komen ertussen te liggen)

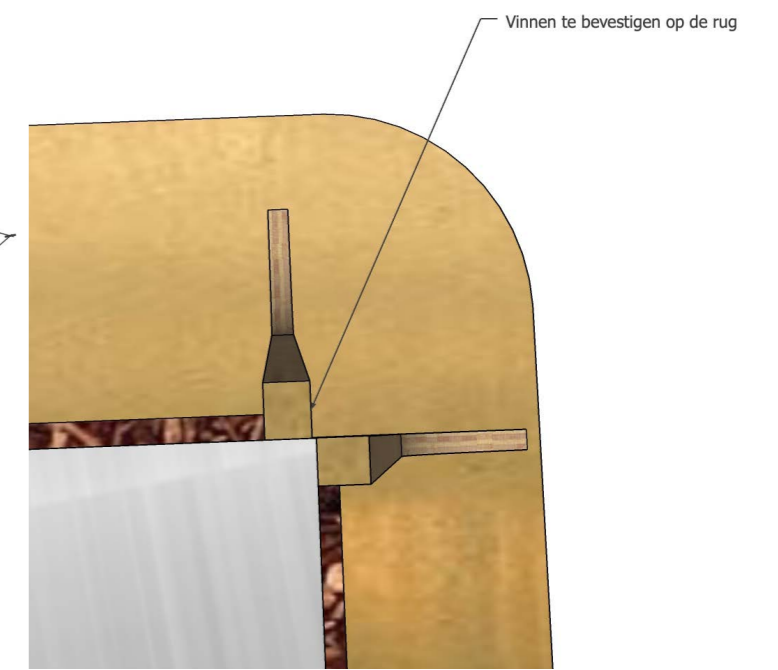

DE_detail hoe vinnen op rug in de hoek te bevestigen (van onder gezien)

DE_snode

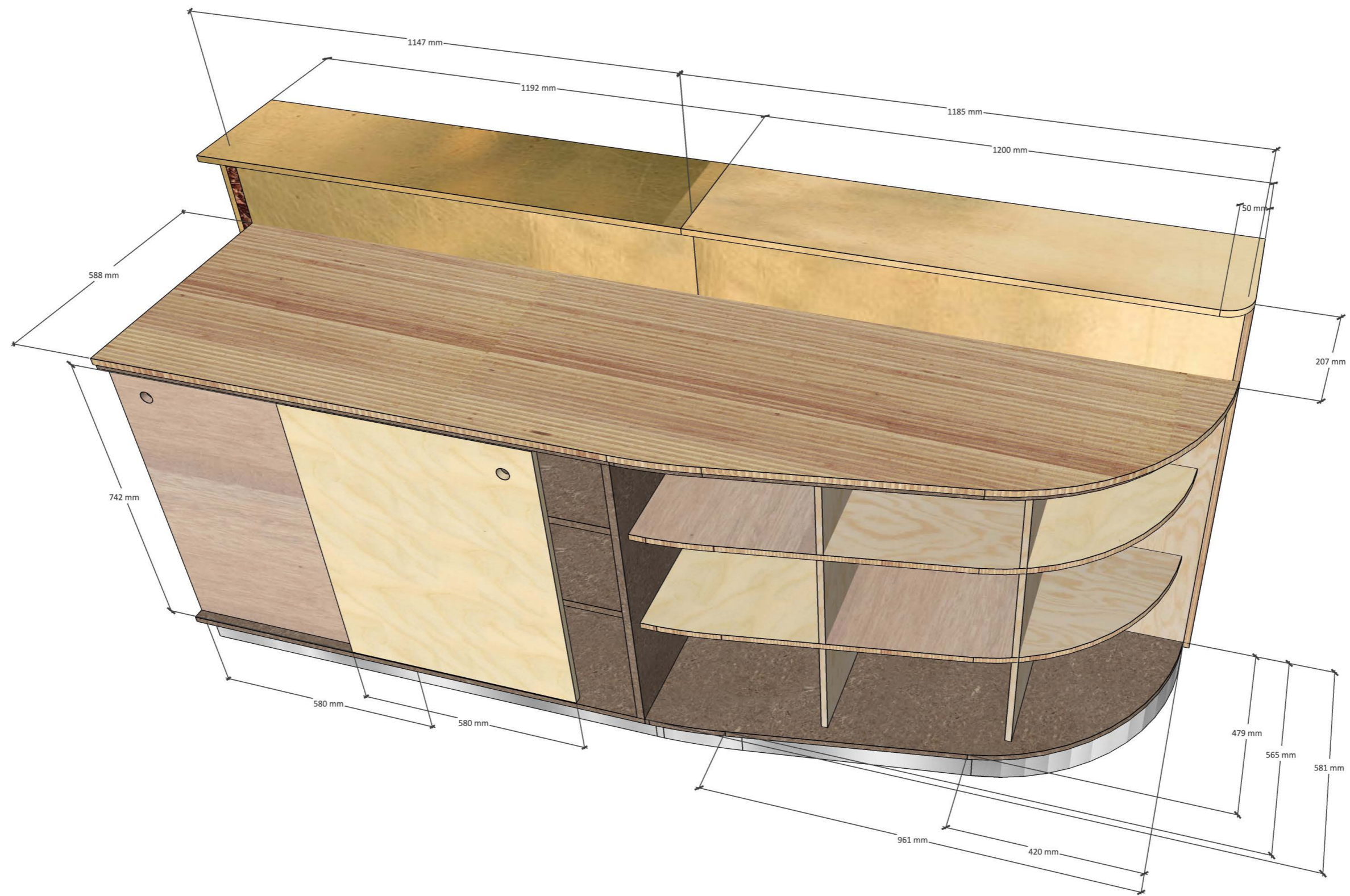

DF_overzicht met fronten

DEEL F

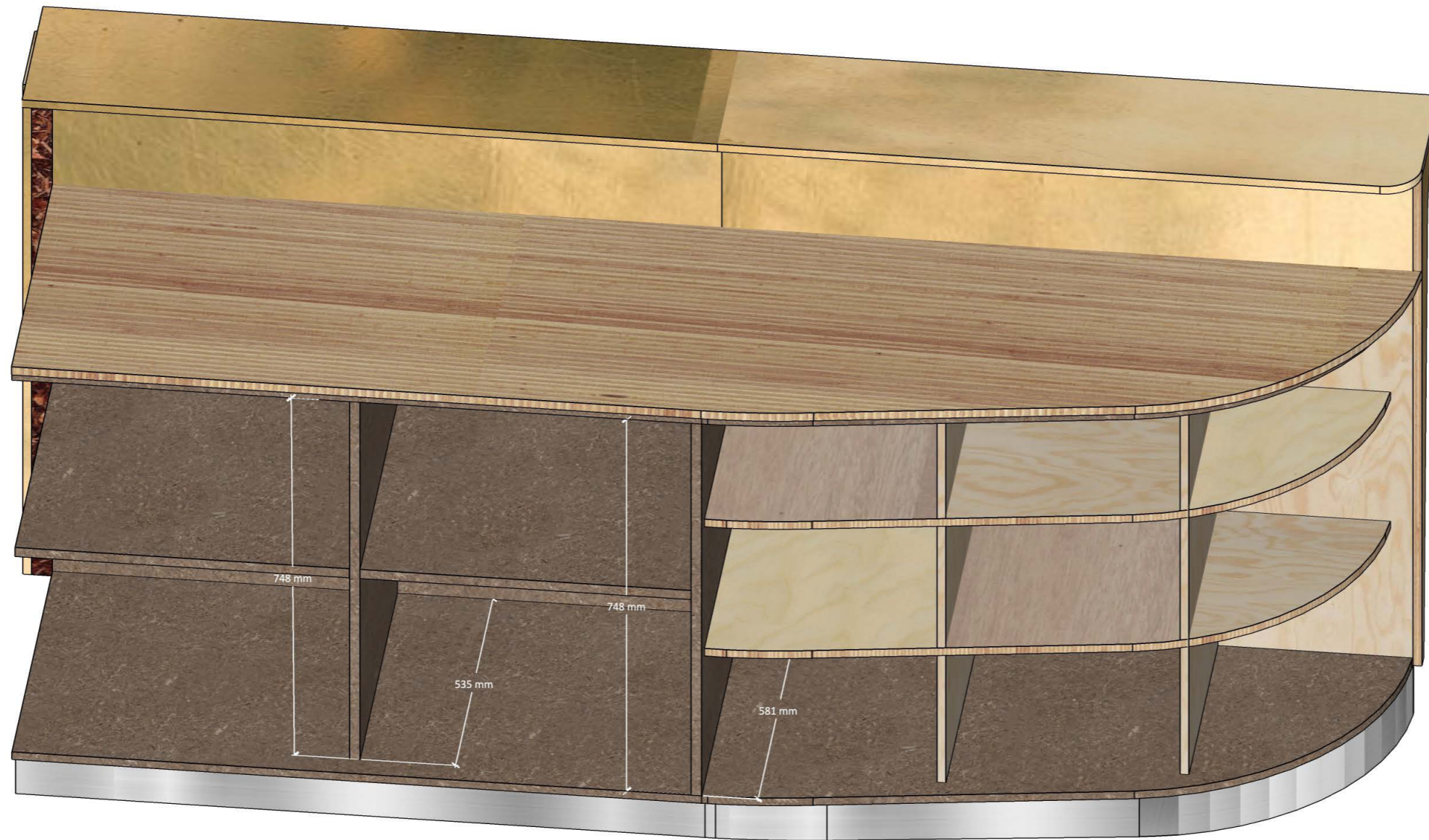

DF_overzicht zonder fronten

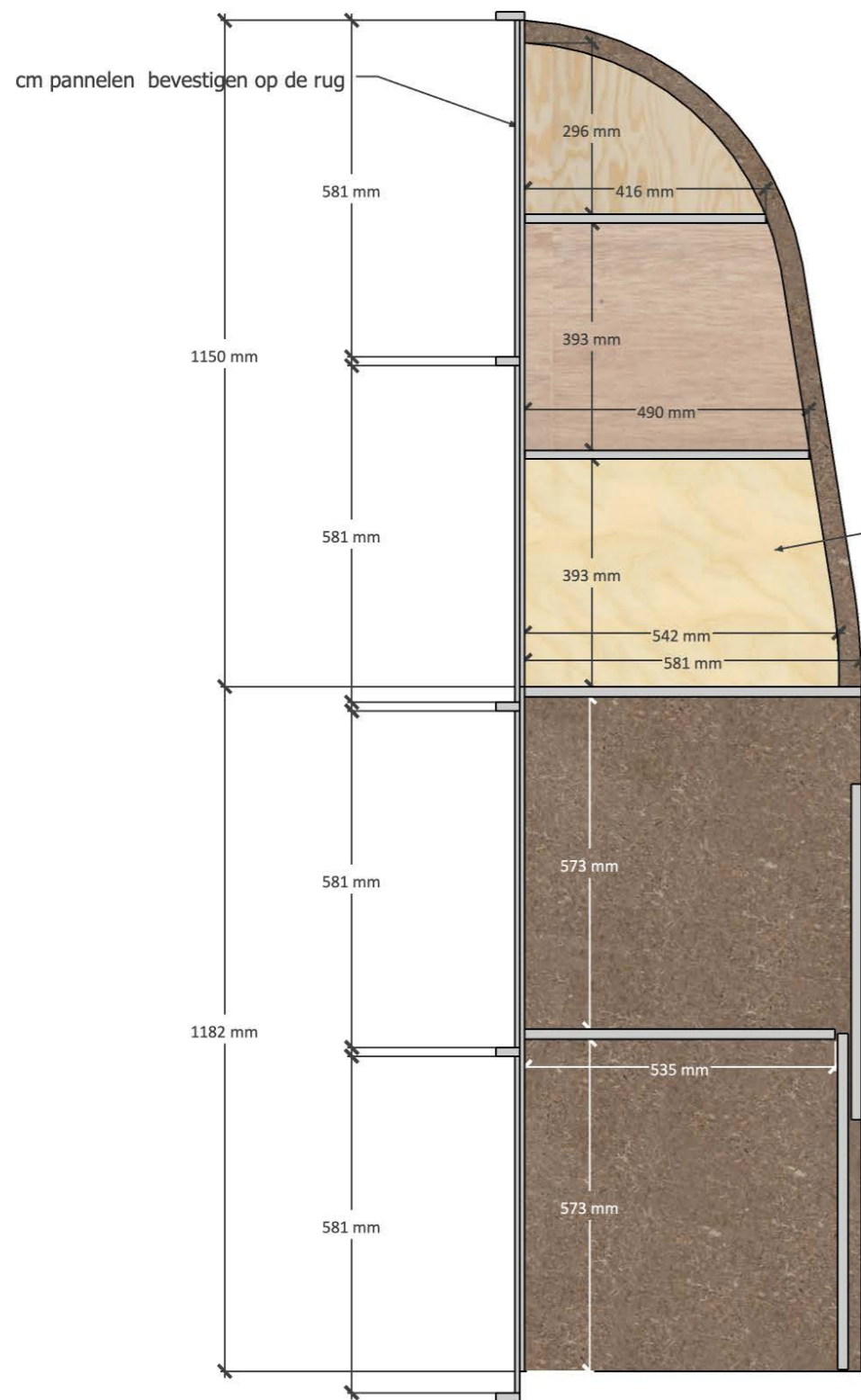

telkens 2 legplanken

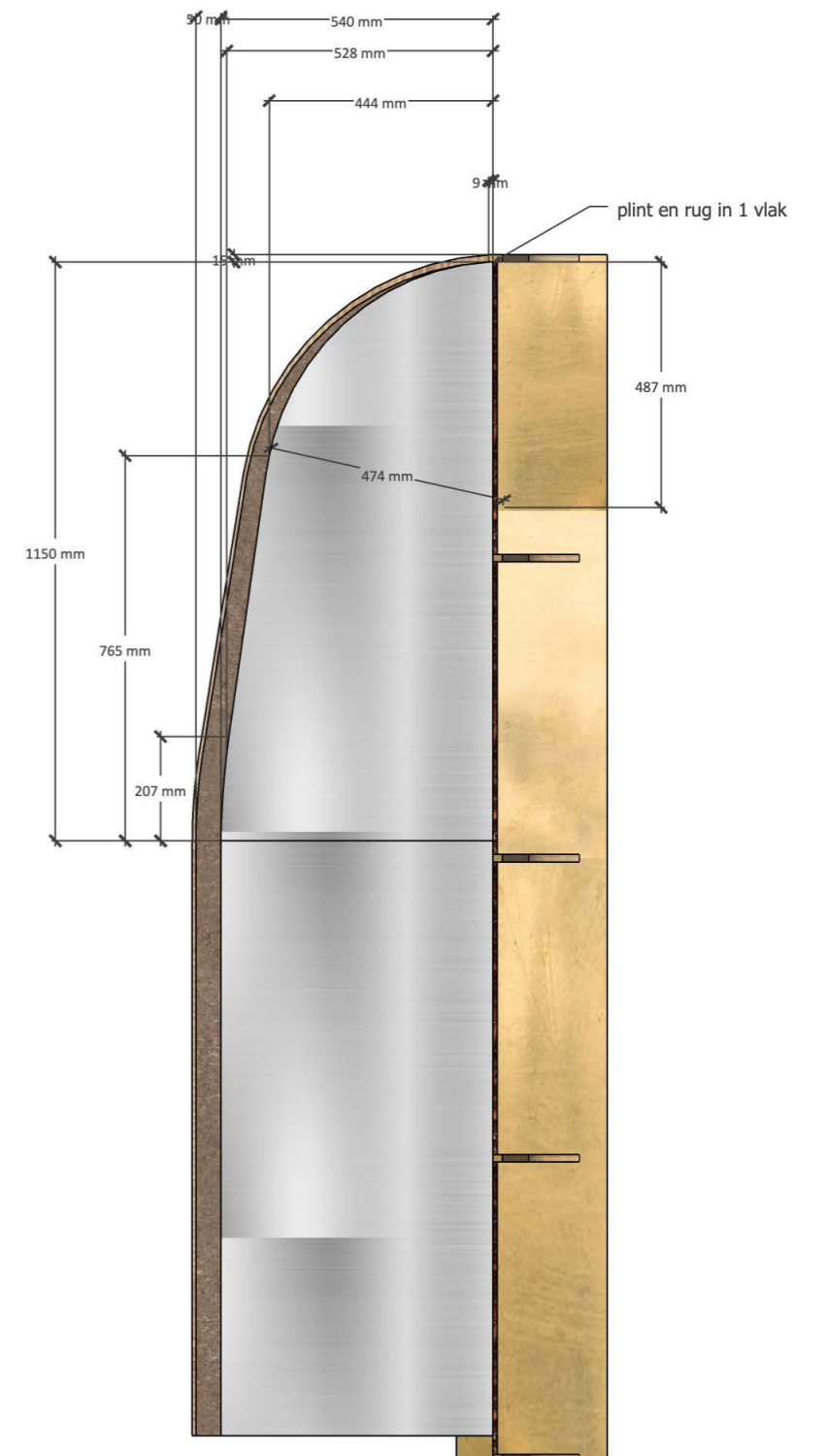
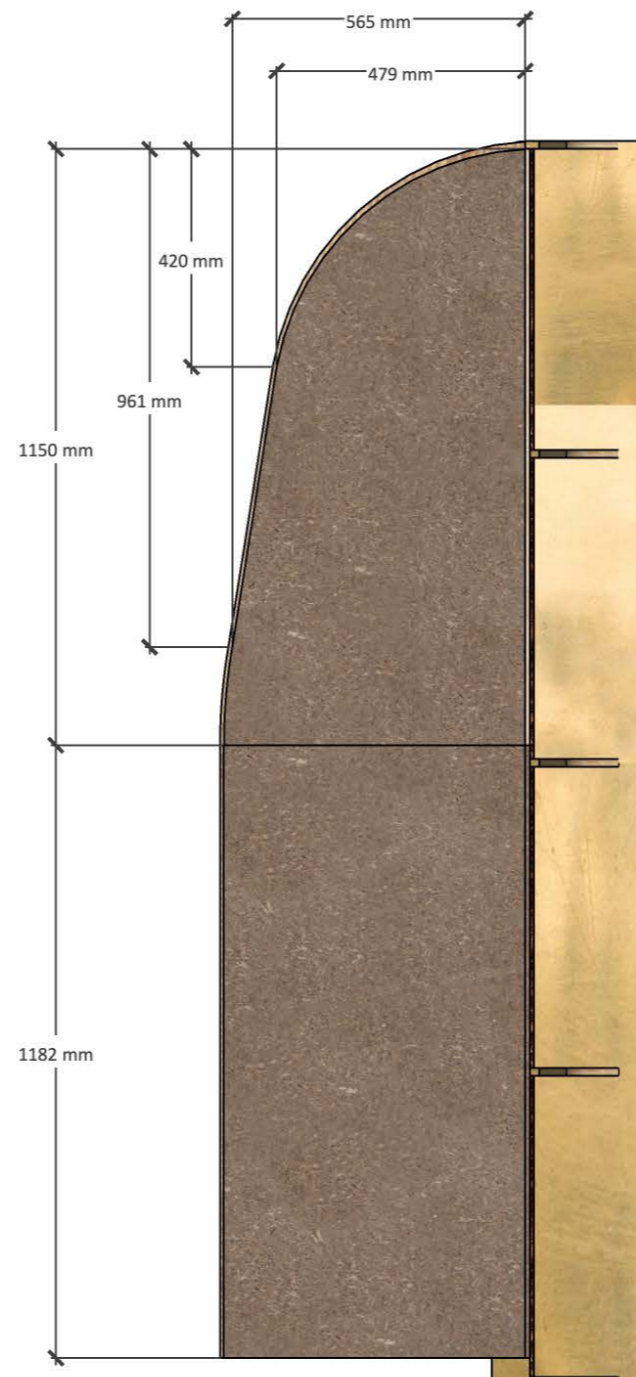

DF_snedede

DF_onderaanzicht zonder sokkel

DF_onderaanzicht met sokkel

grotere vin om rug weg te werken

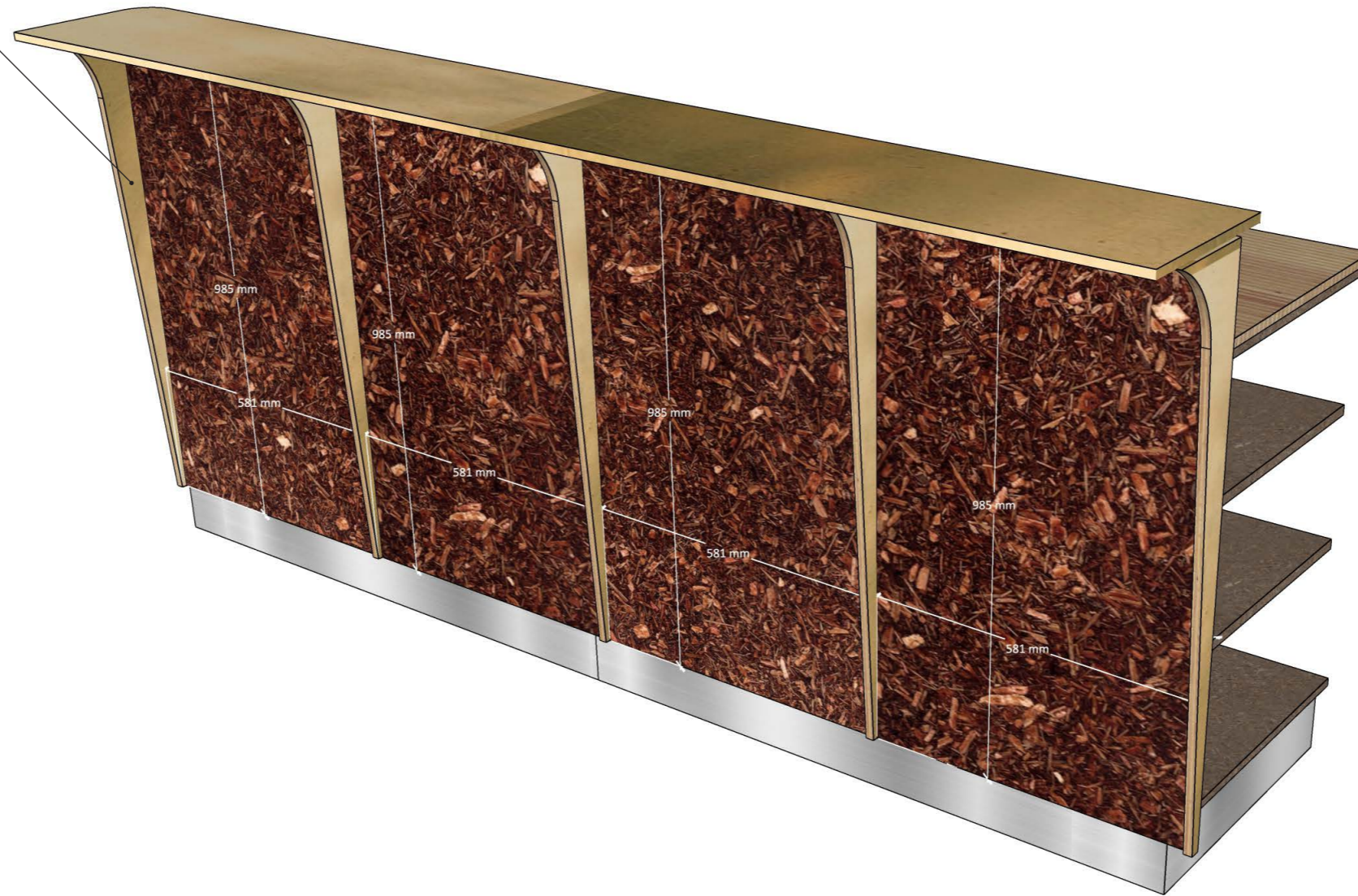

DD_kijkend op de bar vanuit de zaal, afgewerkt met vinnne en CM platen